

FILLET'S MADE FROM
CARDSTOCK

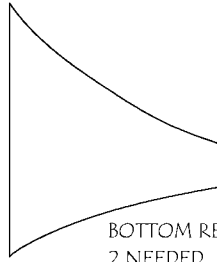

MAIN FILLET- 2 NEEDED



BOTTOM RE
2 NEEDED

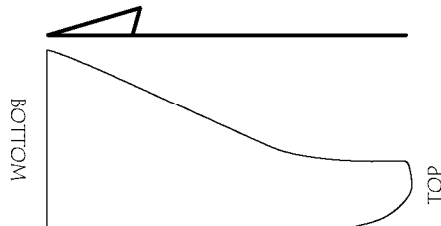

FORWARD FILLET- 2 NEEDED
STARTS ON THE TOP OF THE
WING AT F-2 AND WRAPS OVER
THE TOP OF THE WING ENDING
AT THE BOTTOM OF F-2

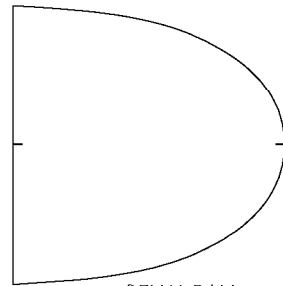

BELLY-PAN
TEMPLATE

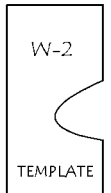

W-2

TEMPLATE



W-3

TEMP

LEADING EDGE TEMP

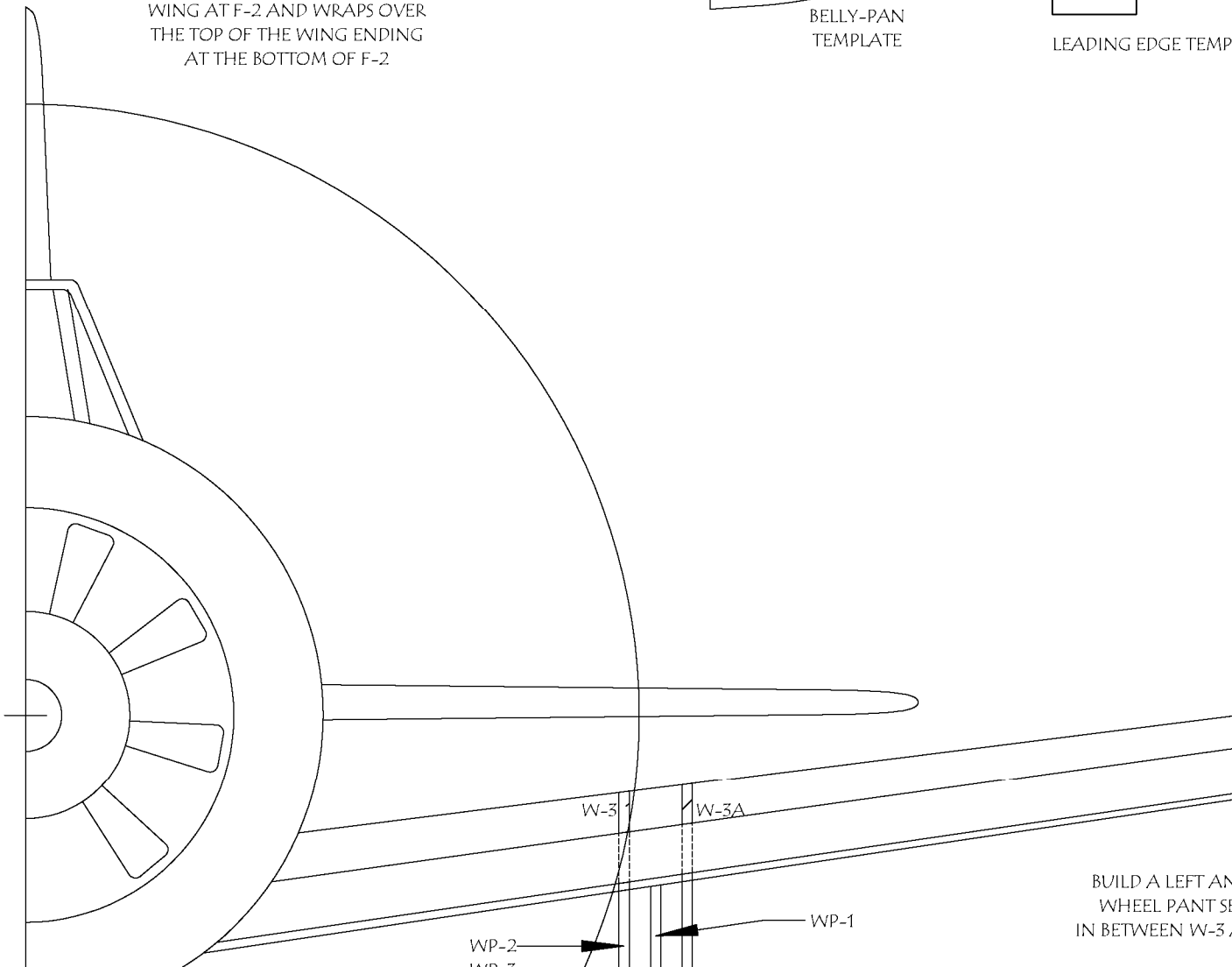

BUILD A LEFT AND
WHEEL PANT SE
IN BETWEEN W-3

EAR FILLET-

8
PLATE

LATES

ND RIGHT
ET. GLUE
AND W-3A

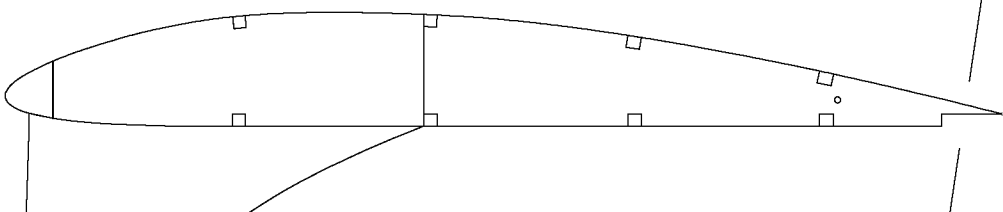
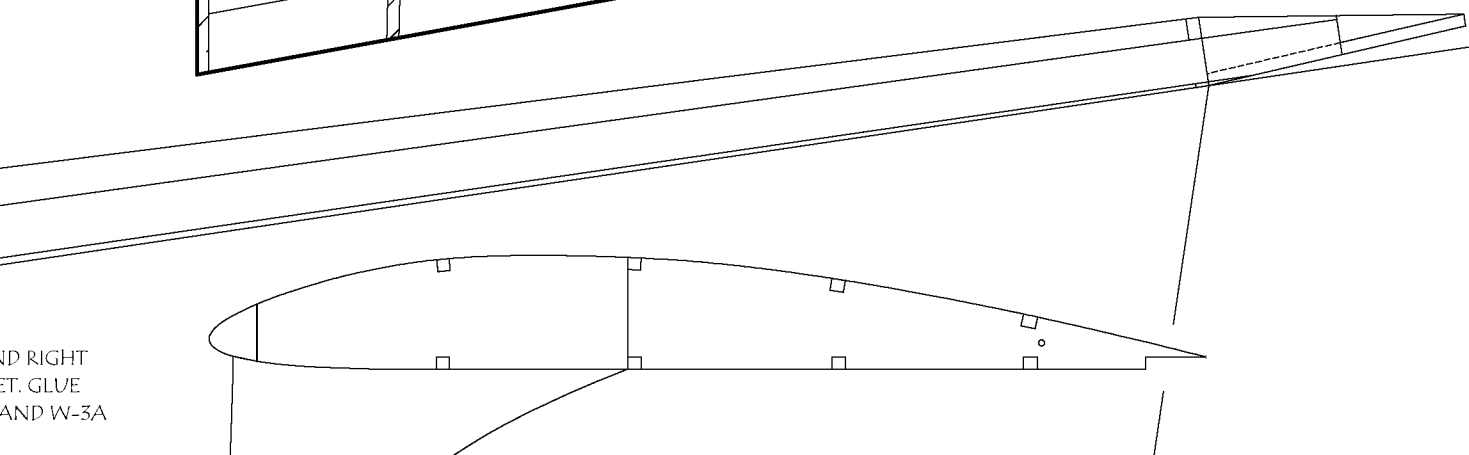
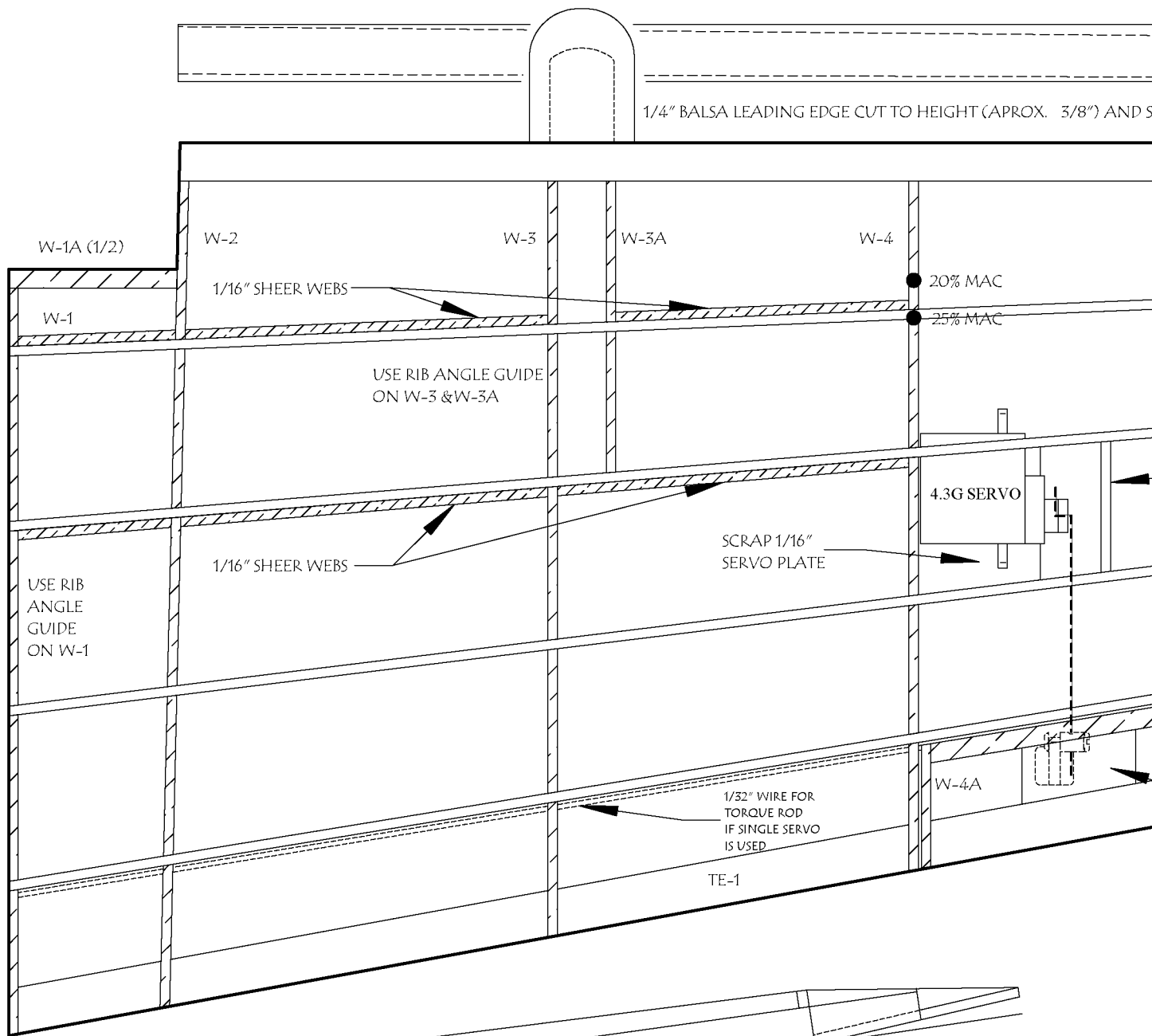

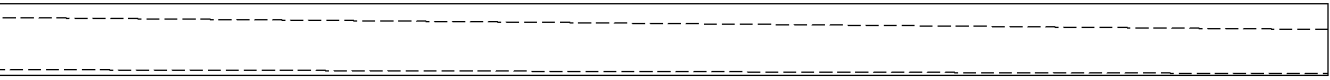

SHAPED TO SHAPE- TOP DASHED LINE REMOVED BEFORE WING HALF IS BUILT- BOTTOM DASHED LINE AFTER

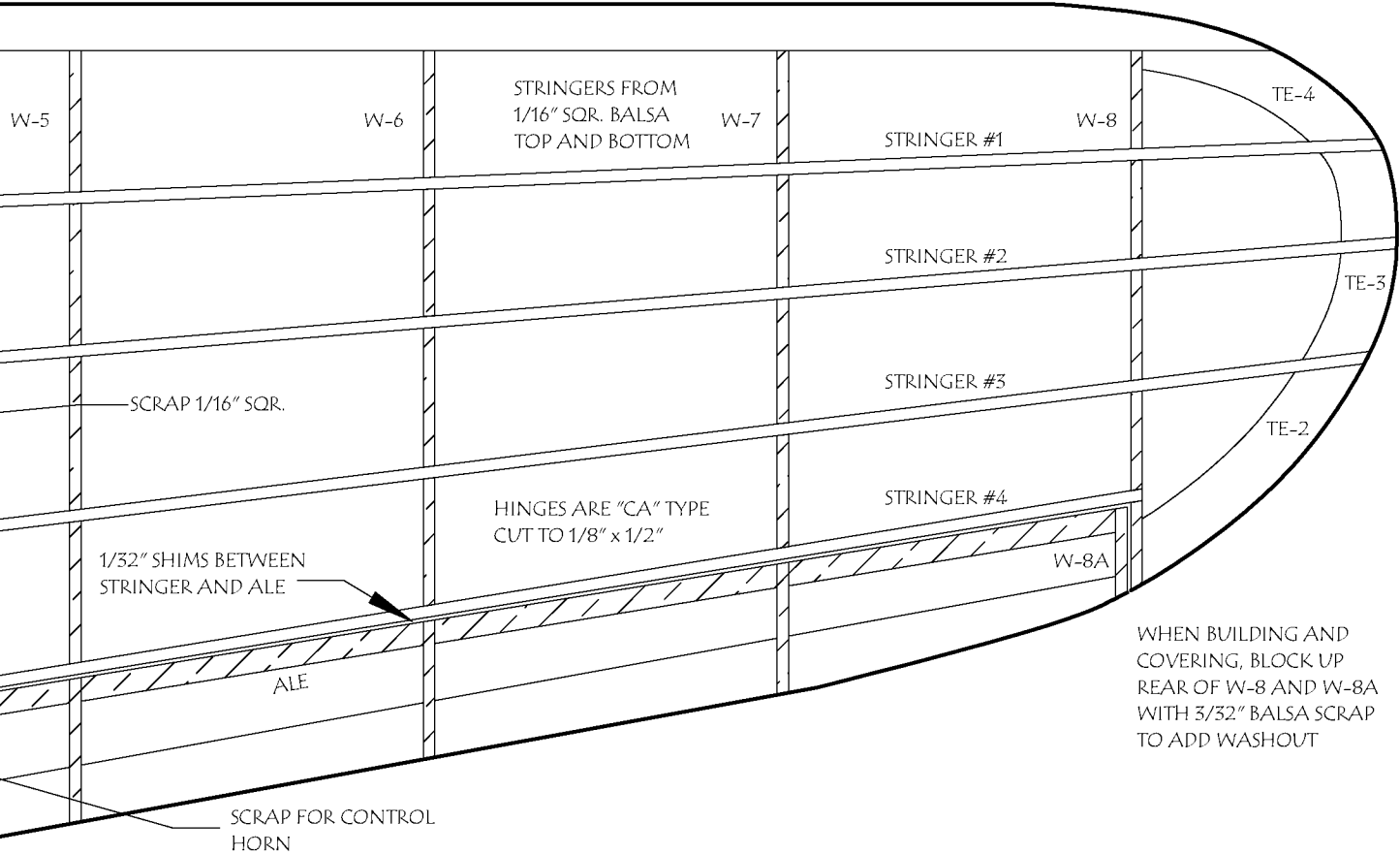

WHEN BUILDING AND COVERING, BLOCK UP REAR OF W-8 AND W-8A WITH 3/32\" BALSA SCRAP TO ADD WASHOUT

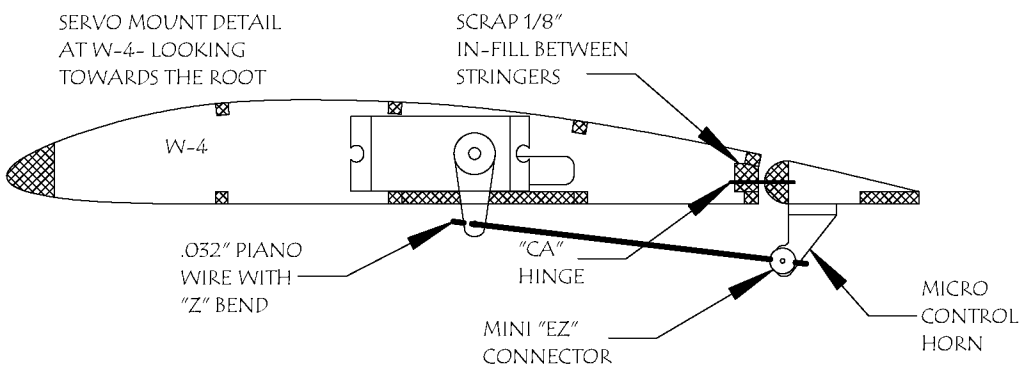

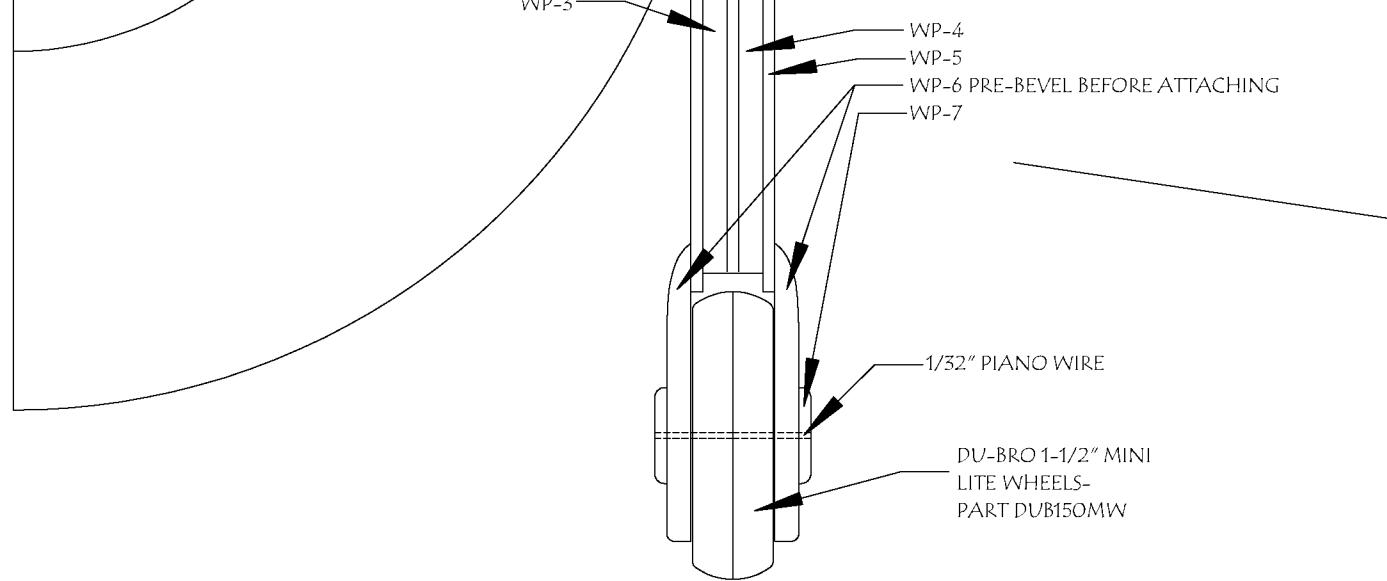

WING CONSTRUCTION

1. PIN LEADING EDGE (1/4" x 3/8"), "TE" PARTS, "ALE", AND BOTTOM STRINGERS #1-3 OVER SHIM UNDER THE REAR OF W-8 PER THE NOTES
2. PIN W-2, W-5, AND W-8 IN PLACE- USE TO ALIGN THE STRINGERS AND MARK THE HEIGHT OF THE LEADING EDGE. REMOVE THE LEADING EDGE AND PRE-TRIM ALONG THE TOP PANEL
3. RE-PIN LEADING EDGE IN PLACE AND ADD W-4, W-6, AND W-7 IN PLACE AND GLUE
4. USING THE RIB ANGLE GUIDE, GLUE W-1 AND W-3 IN PLACE. USE THE APPLICABLE PANEL TO SET THE SPACING FOR W-3A AND GLUE IN PLACE
5. ADD W-4A AND W-8A IN PLACE AND GLUE, THEN ADD ALL THE TOP STRINGERS
6. ADD 1/16" SHEER WEBS PER THE PLANS
7. REMOVE PANEL FROM BOARD, ADD BOTTOM STRINGER #4, AND ROUND LEADING EDGE
8. REPEAT FOR THE OTHER PANEL
9. WITH ONE PANEL FLAT ON THE BOARD, PROP UP THE OTHER PANEL 4" AT W-8 AND CLAMP
10. ADD W-1A, CUT THE AILERONS FREE (ROUND LEADING EDGE)
11. IN-FILL BETWEEN TOP AND BOTTOM #4 STRINGERS WITH SCRAP Balsa- HINGE AILERONS AND MOUNT SERVOS- SEE W-4 DETAIL
12. CUT STRINGER #1 ON THE BOTTOM BETWEEN BETWEEN W-3 AND W-3A FOR THE PANEL
13. ATTACH THE PANTS/SPATS AFTER COVERING

KI-27 NATE

DESIGNED BY DEREK MICKO

30" WINGSPAN

6-9 OUNCES

CHANNELS: 4

MOTOR: 18-24 GRAM

ALL RIGHTS RESERVED

Sheet 2 of 2 Plan No. 1127



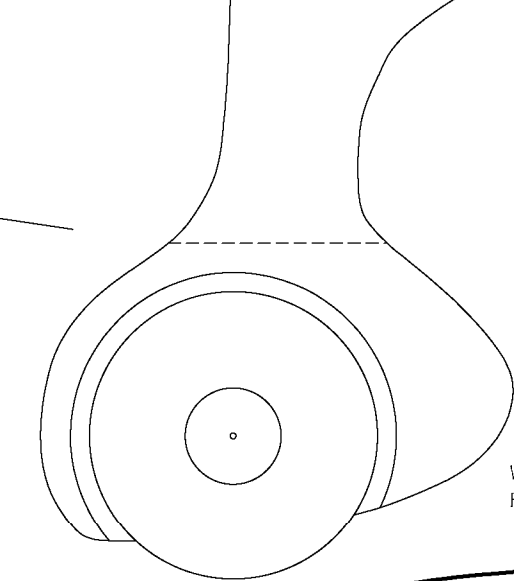

WING DIHEDRAL 4" AT W-8 WITH 1 WING SIDE FLAT

WP-4 AND 5 OMITTED FOR CLARITY

1/4" Balsa LEADING E

PLANS-
GHT
MARKED LINES
TS /SPAT
E
GLUE
ONS TO THIS
TS/SPATS

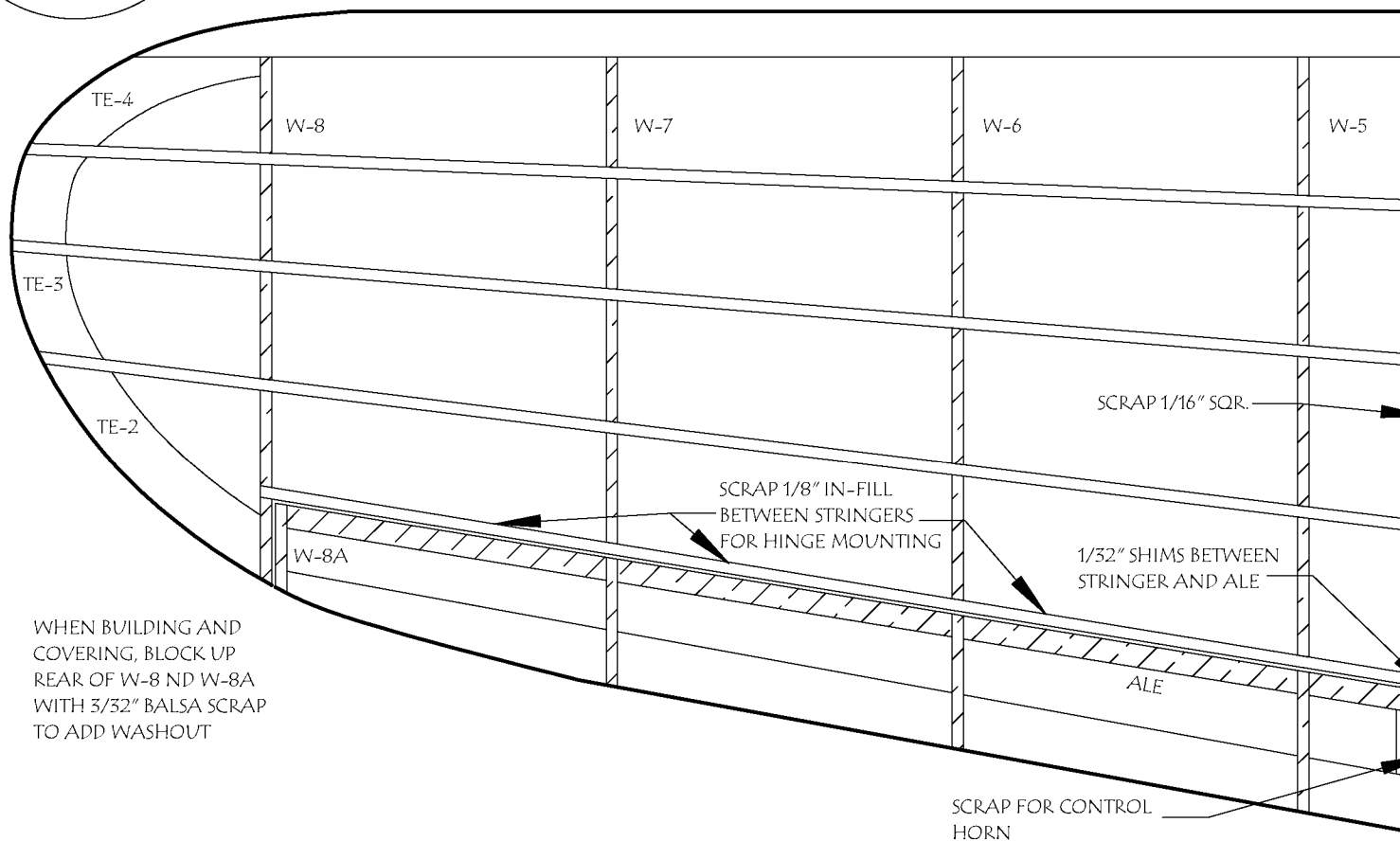

WHEN BUILDING AND COVERING, BLOCK UP REAR OF W-8 AND W-8A WITH 3/32" Balsa SCRAP TO ADD WASHOUT





Copying for resale of this drawing without the written approval or consent of AMA is expressly prohibited.

