

8

1/16" Ply--make 1 o

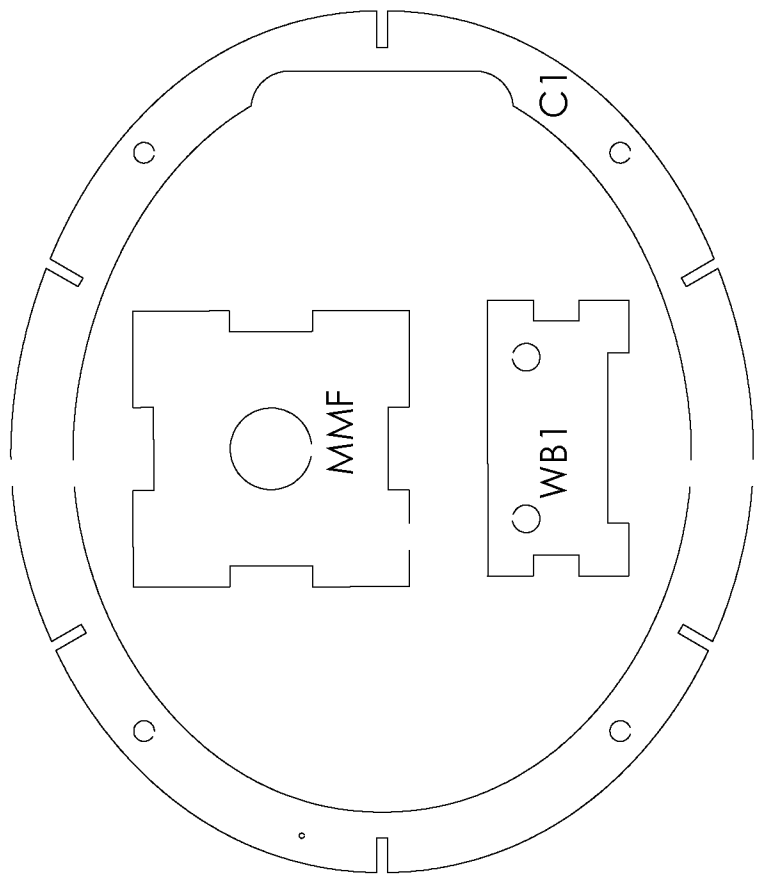

F

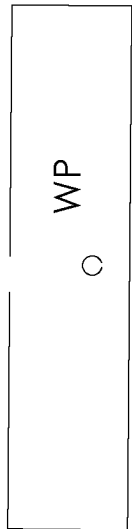

E

7

of each part

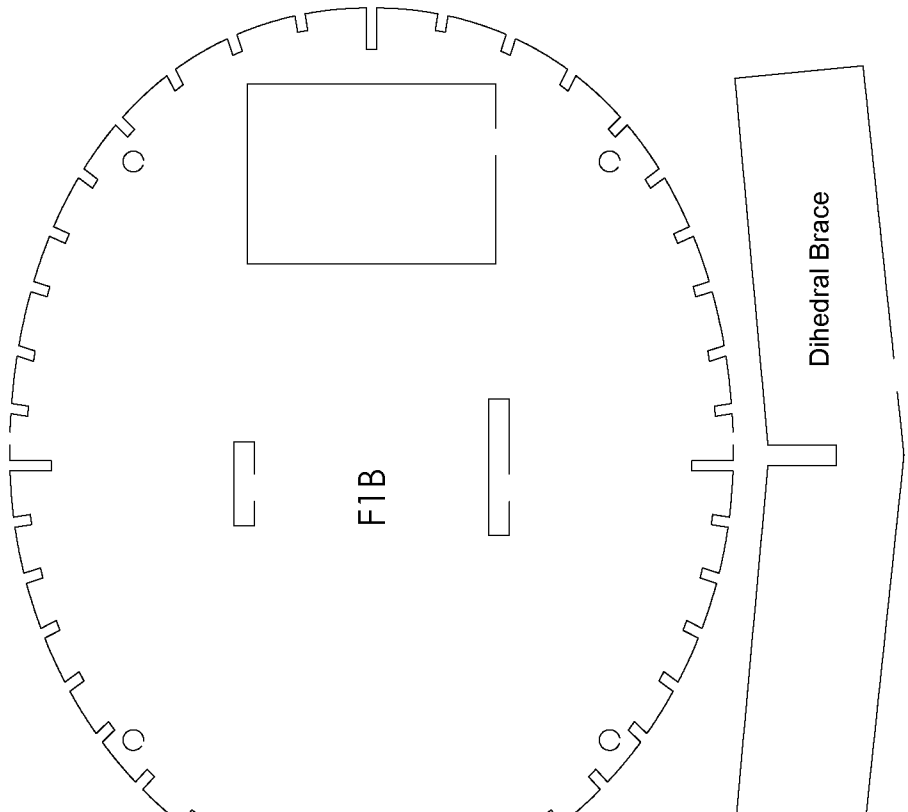

6

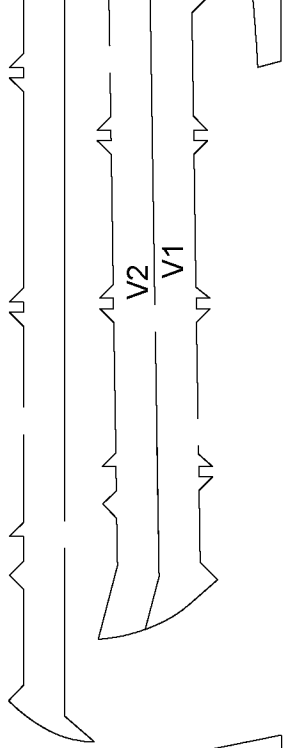
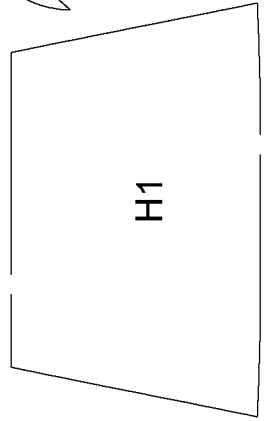
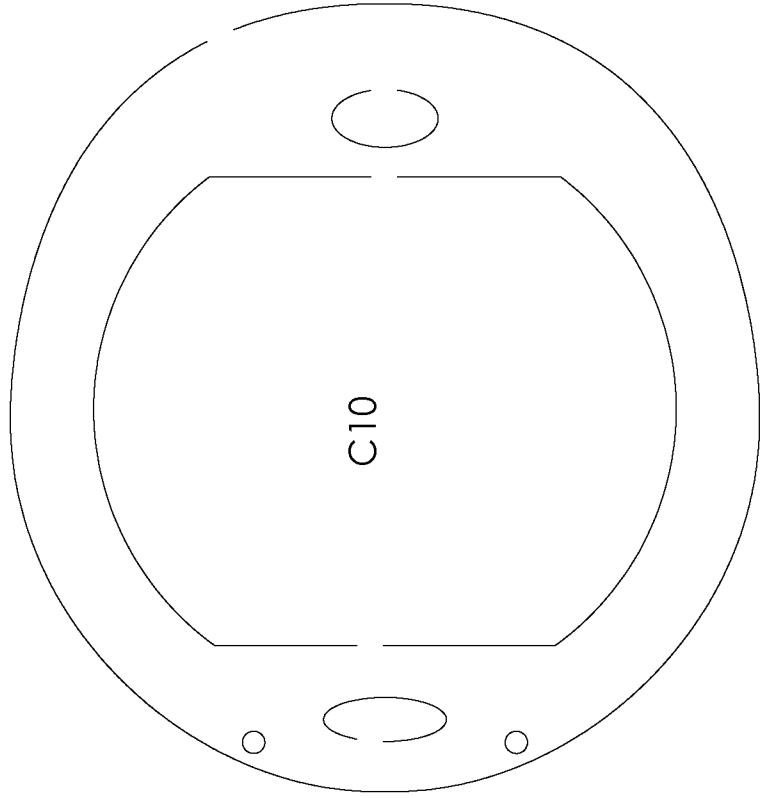

5

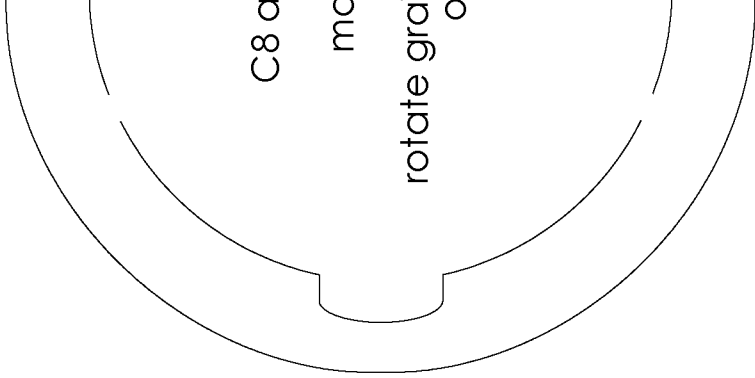

4

3

2

1/18" Balsa--make 1 of each part unless noted

1/8" unless

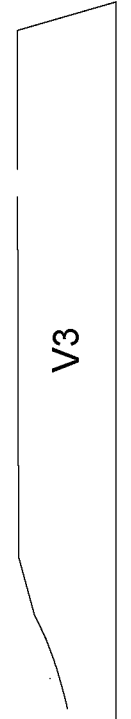
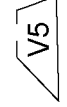
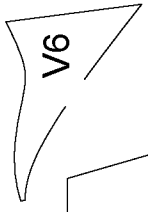
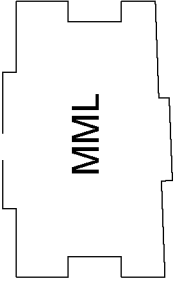
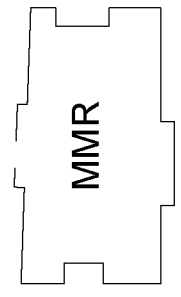
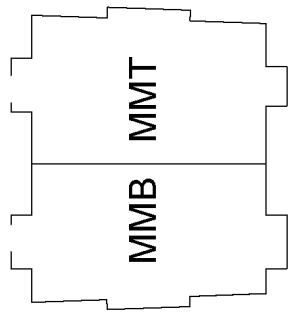
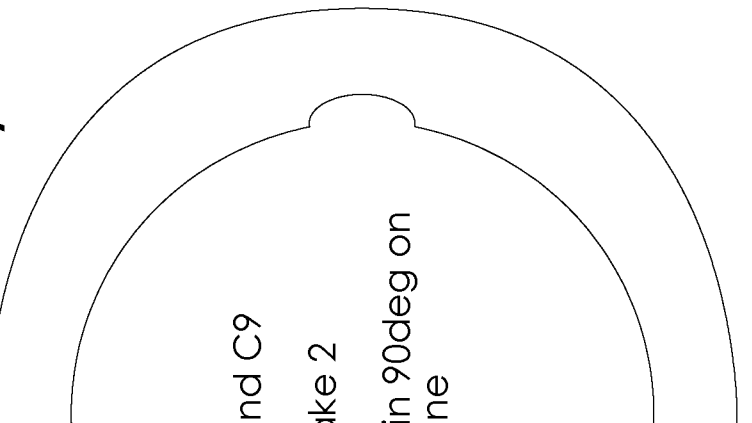
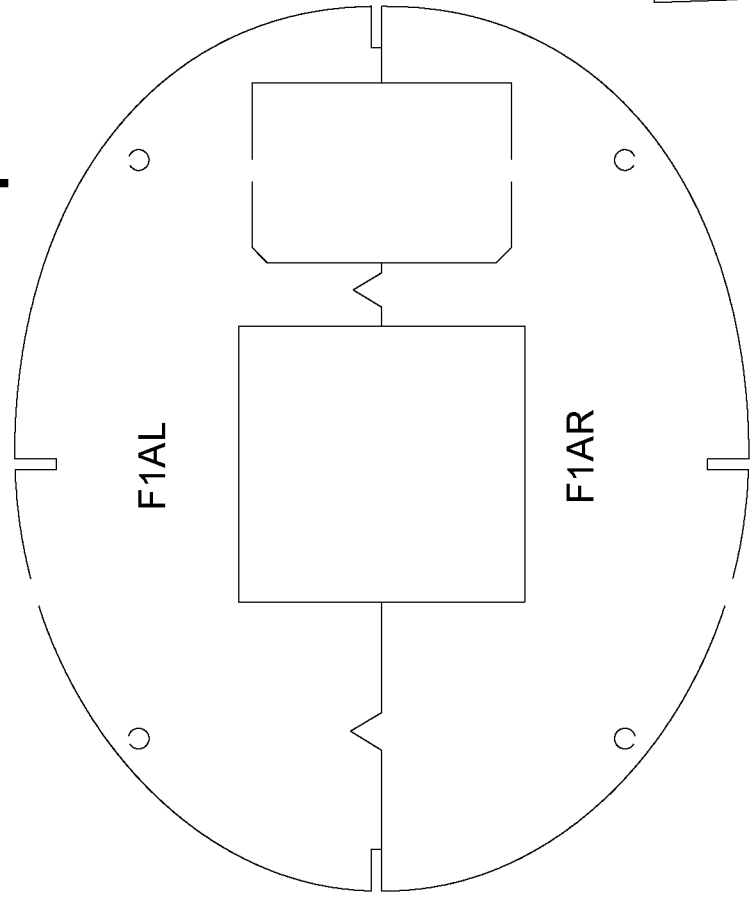

H2

V6

V4

V3

V5

MMB MMT

MMR

MML

V6

V4

V3

V5

H3

nd C9

like 2

in 90deg on
line

1

**Balsa--make 2 of each part
as noted**

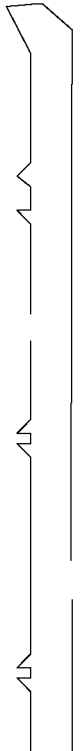
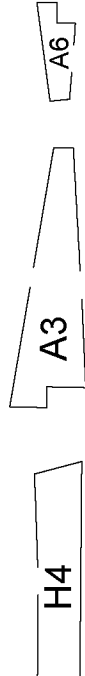
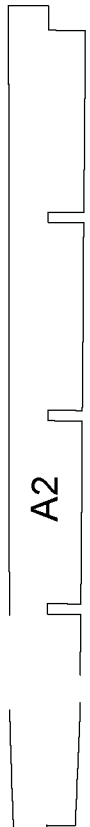
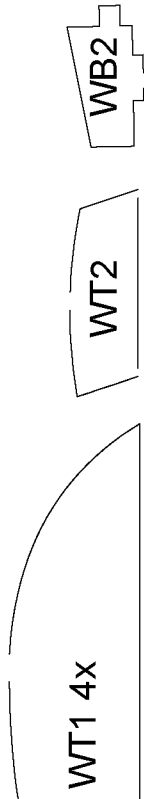

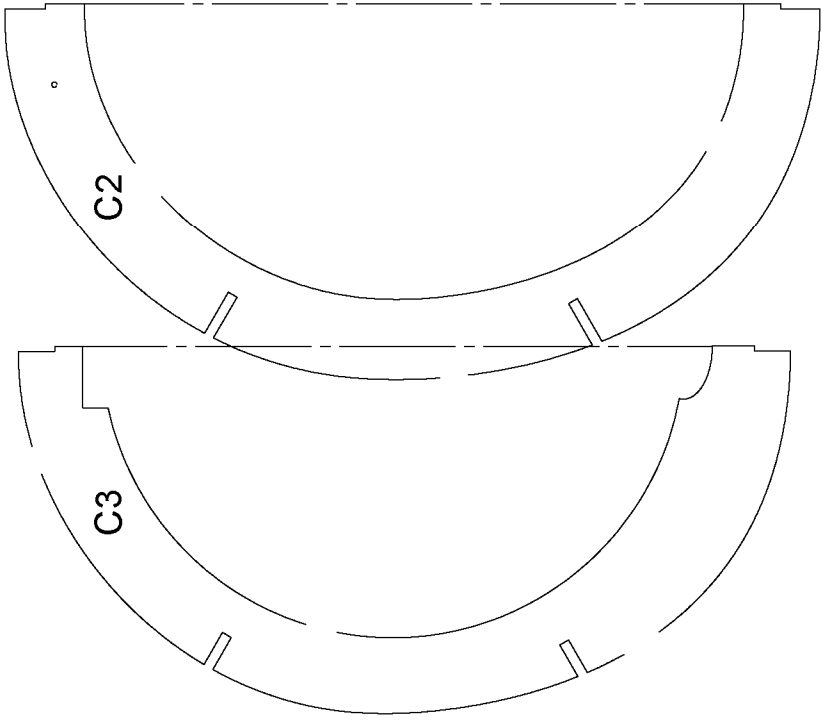
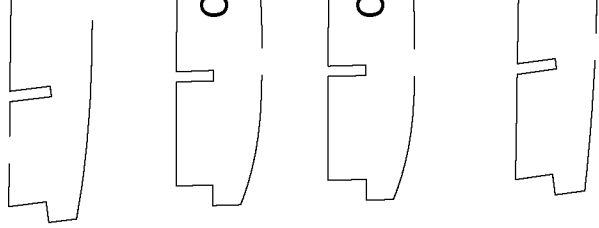

D

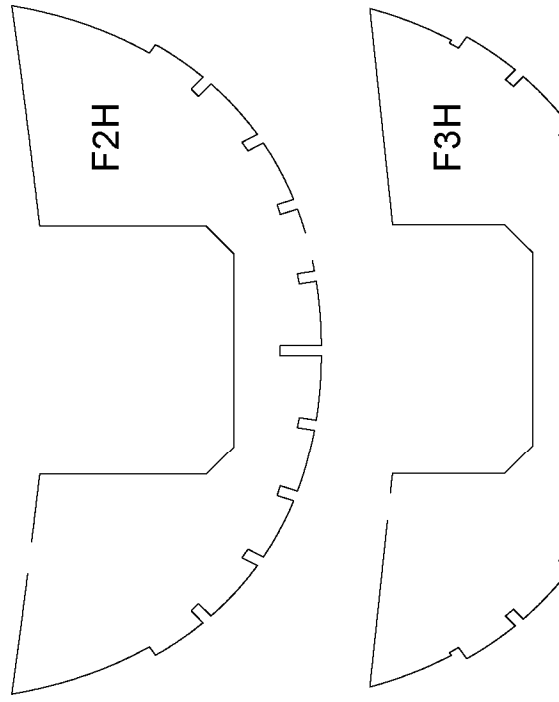

C

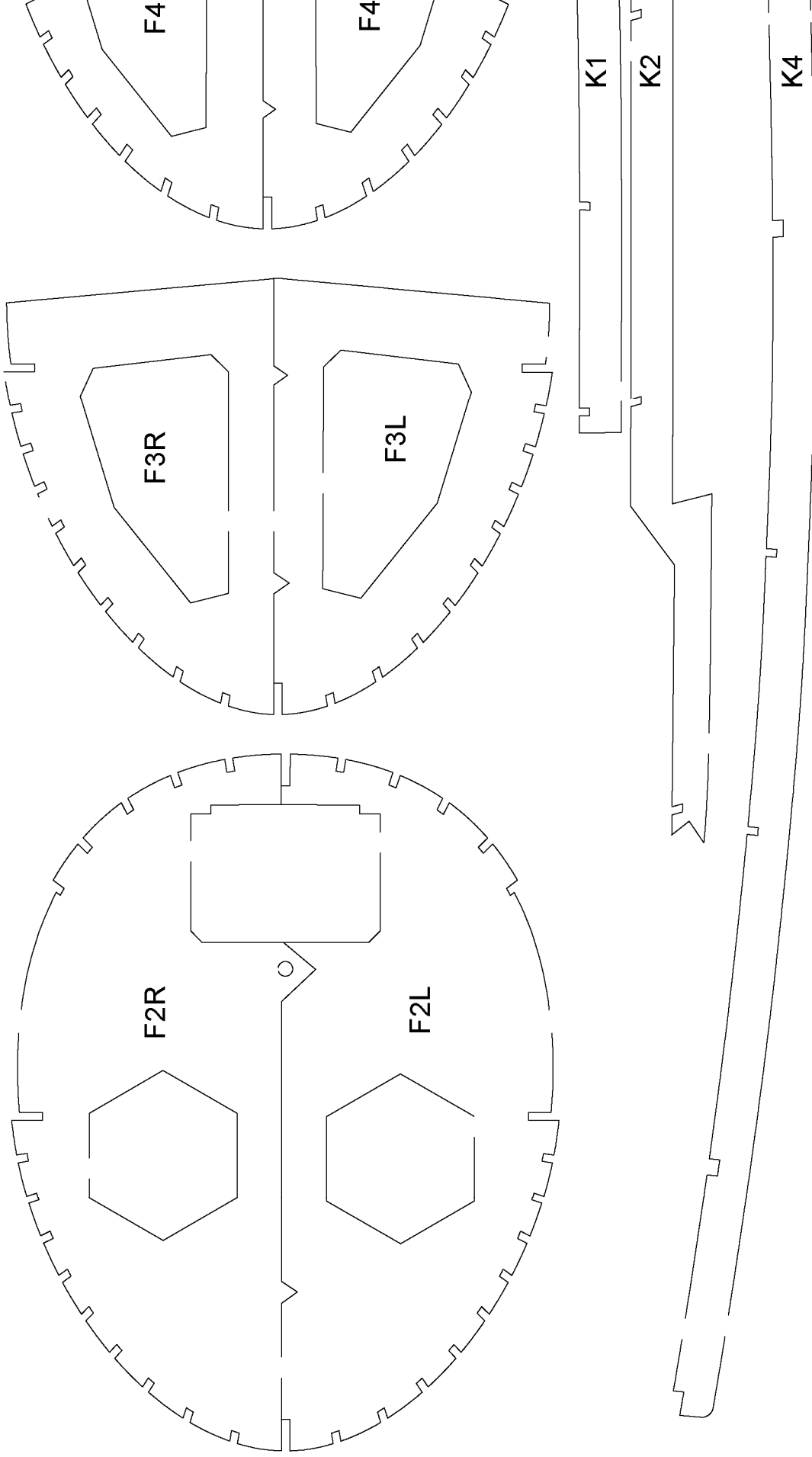

1/16" Balsa--make 1 of

1/16" Balsa--make 2 of

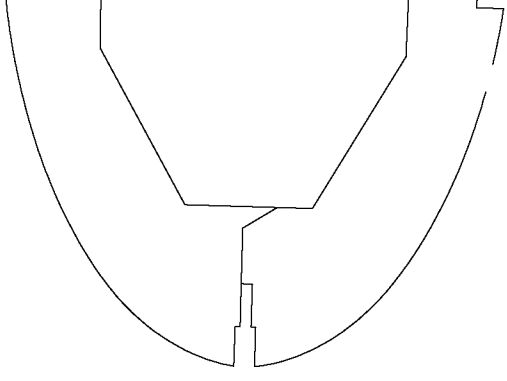
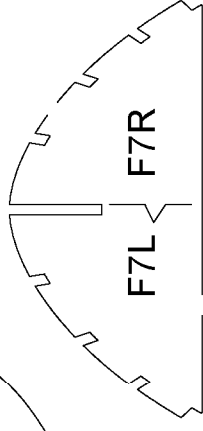
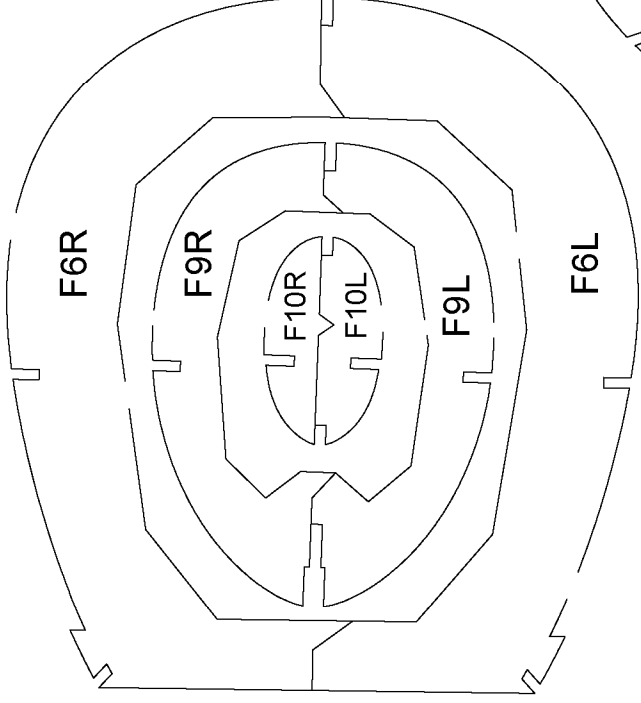
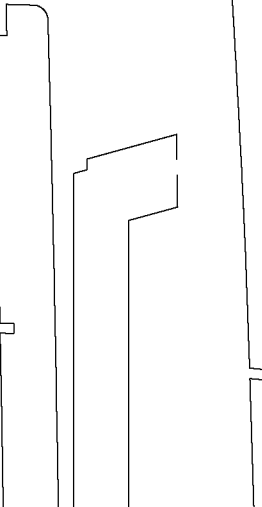
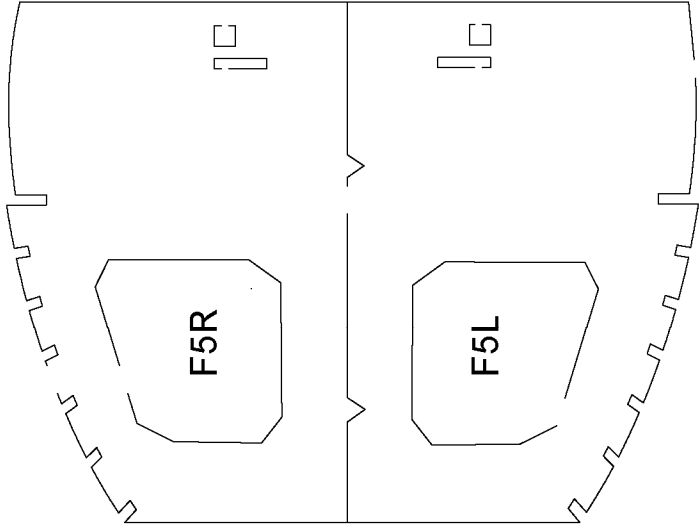
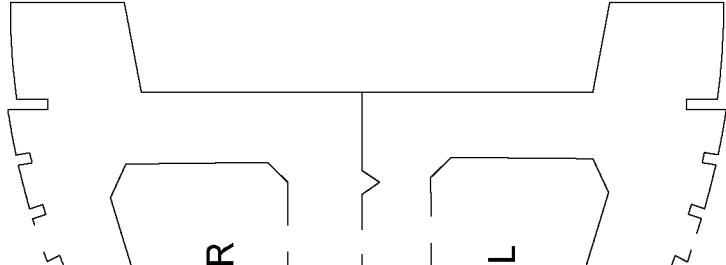

each part unless noted

each part unless noted

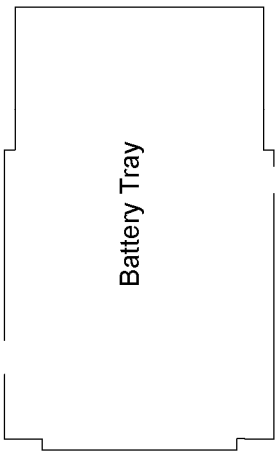

F8R

F8L

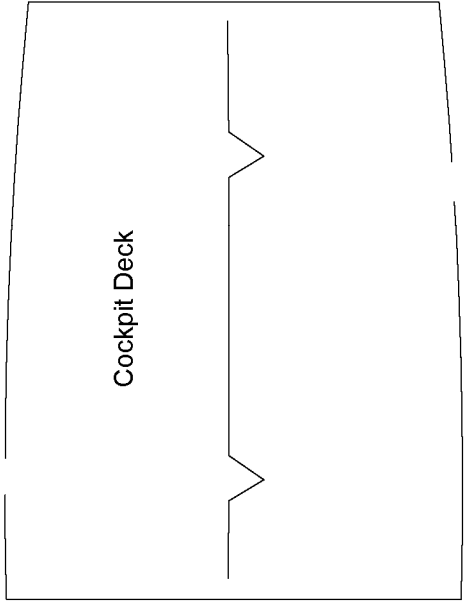

Cockpit Deck

D

C



W8

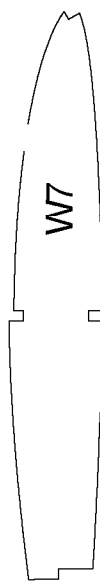

W7

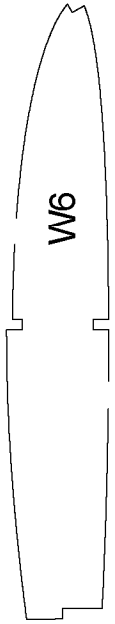

W6



A4 6X

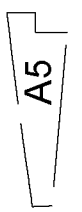

A5

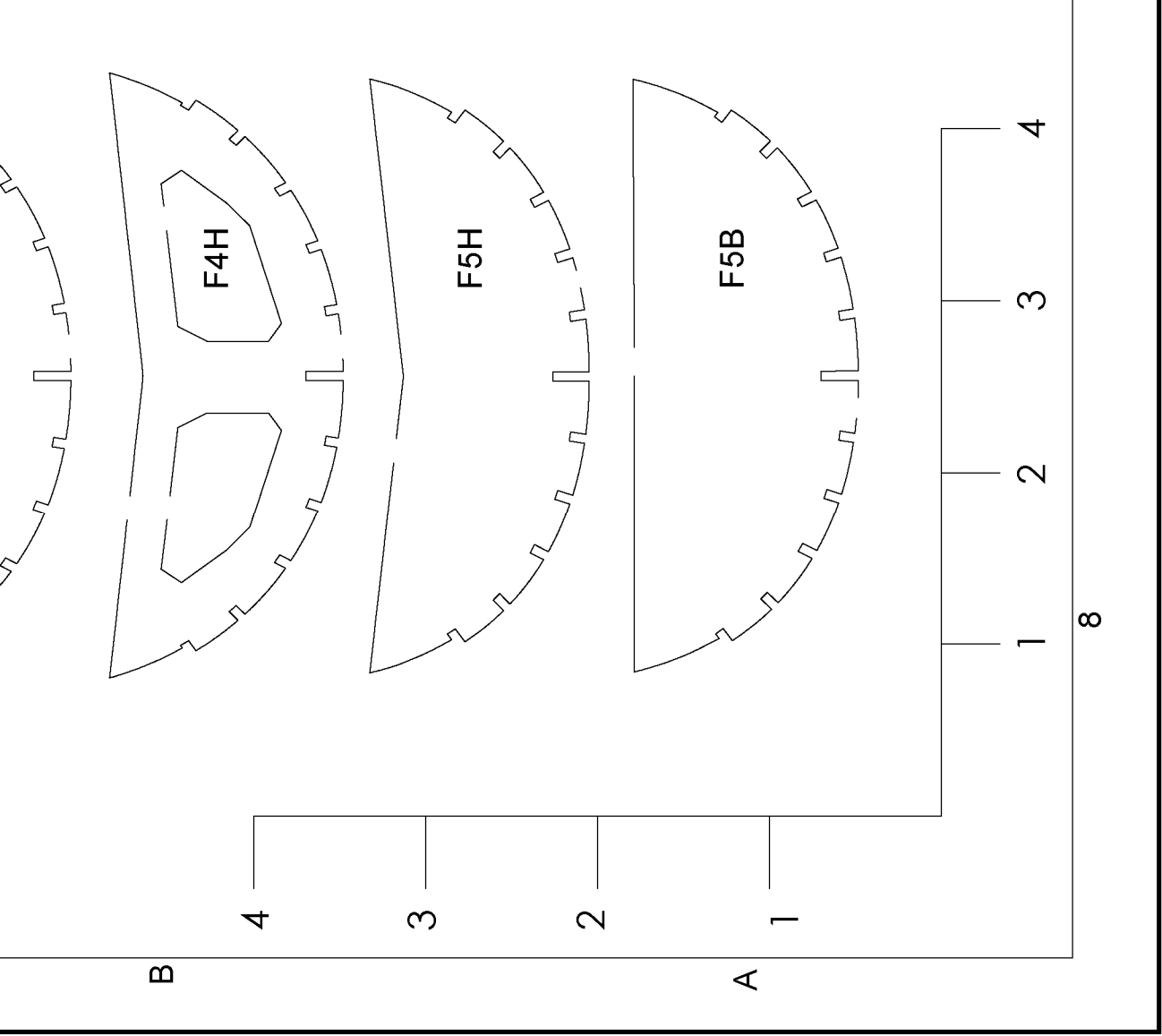

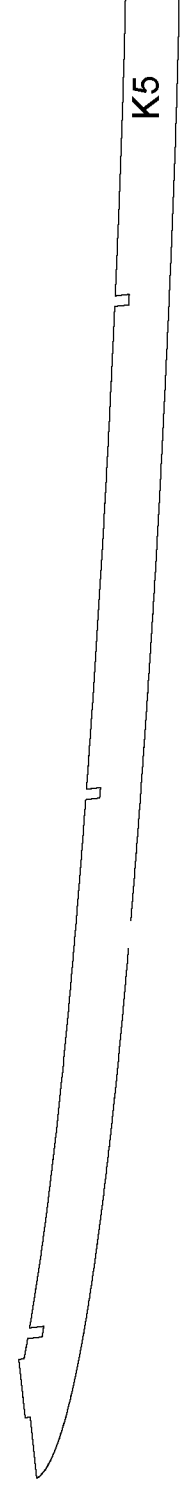
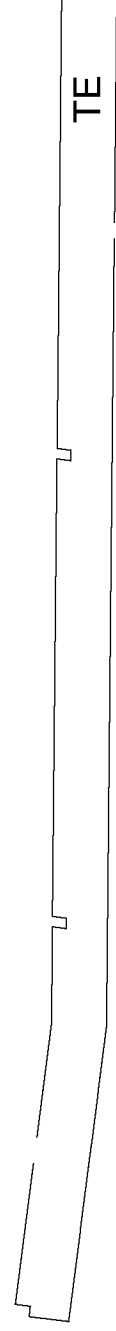
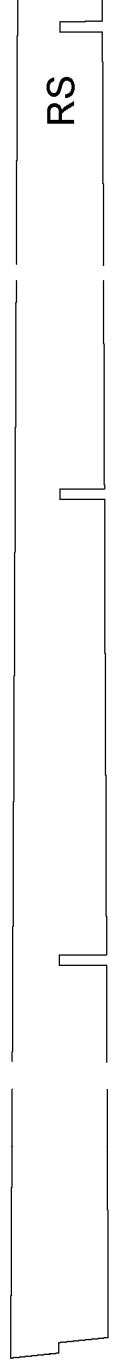
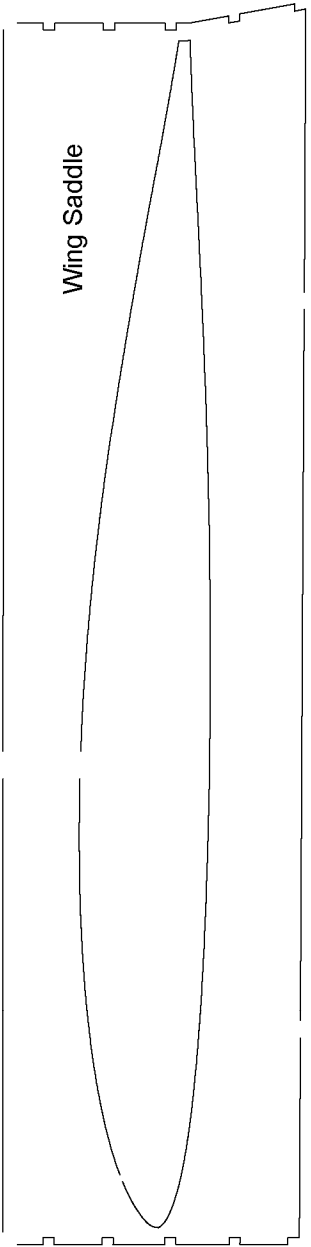

S6

S5

S4

S3

S2

S1

A1



Copyright 2021

and **ModelAviation**

Copying for resale of this drawing without the written approval or consent of AMA is expressly prohibited.

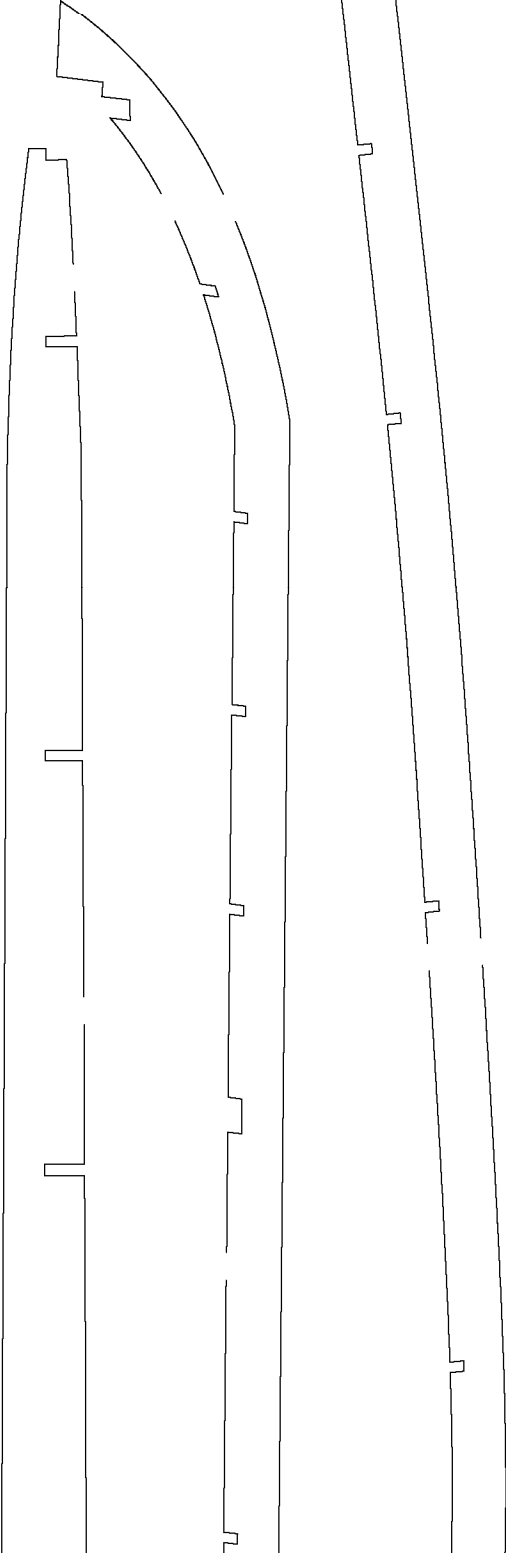

4

3

2

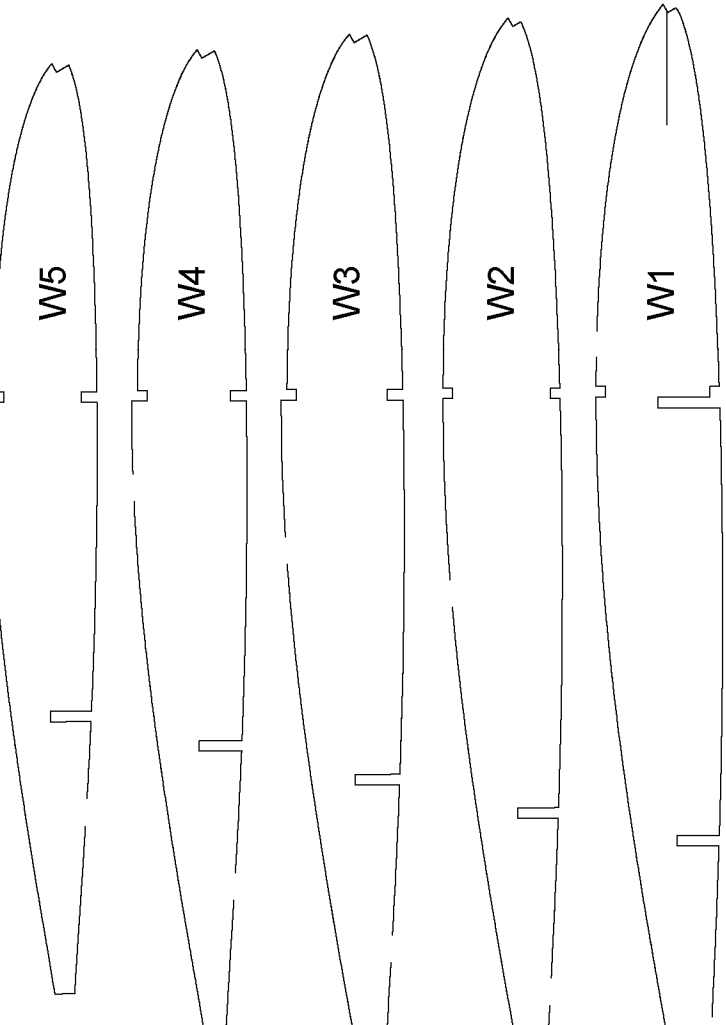

B

Plan No. 1129

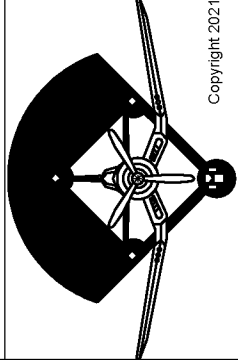
 <p>Copyright 2021 www.infieldengineering.com</p>		<p>INFIELD ENGINEERING^{im} by Paul Kohlmann</p>	
<p>Title 30" Brewster F2A Buffalo</p>		<p>Size D</p>	<p>Dwg. No. F2A-1 Buffalo 30 plan</p>
<p>Laser cut kit available! www.infieldengineering.com</p>		<p>Scale: 1:1</p>	<p>Rev A</p>
		<p>Weight: 10-12oz</p>	<p>Sheet 2 of 2</p>

A