

30 ⁷/₈

1 inch

TE Jig

Illustration-not to scale

Servo Box
and
Air Vent

$\frac{3}{8}$ X $\frac{3}{4}$ cardboard
wiring tunnel

CL
Original

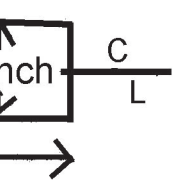

CL
Original

2

This nacelle
position for
10-inch propeller
with 5/16-inch
added to
wing root

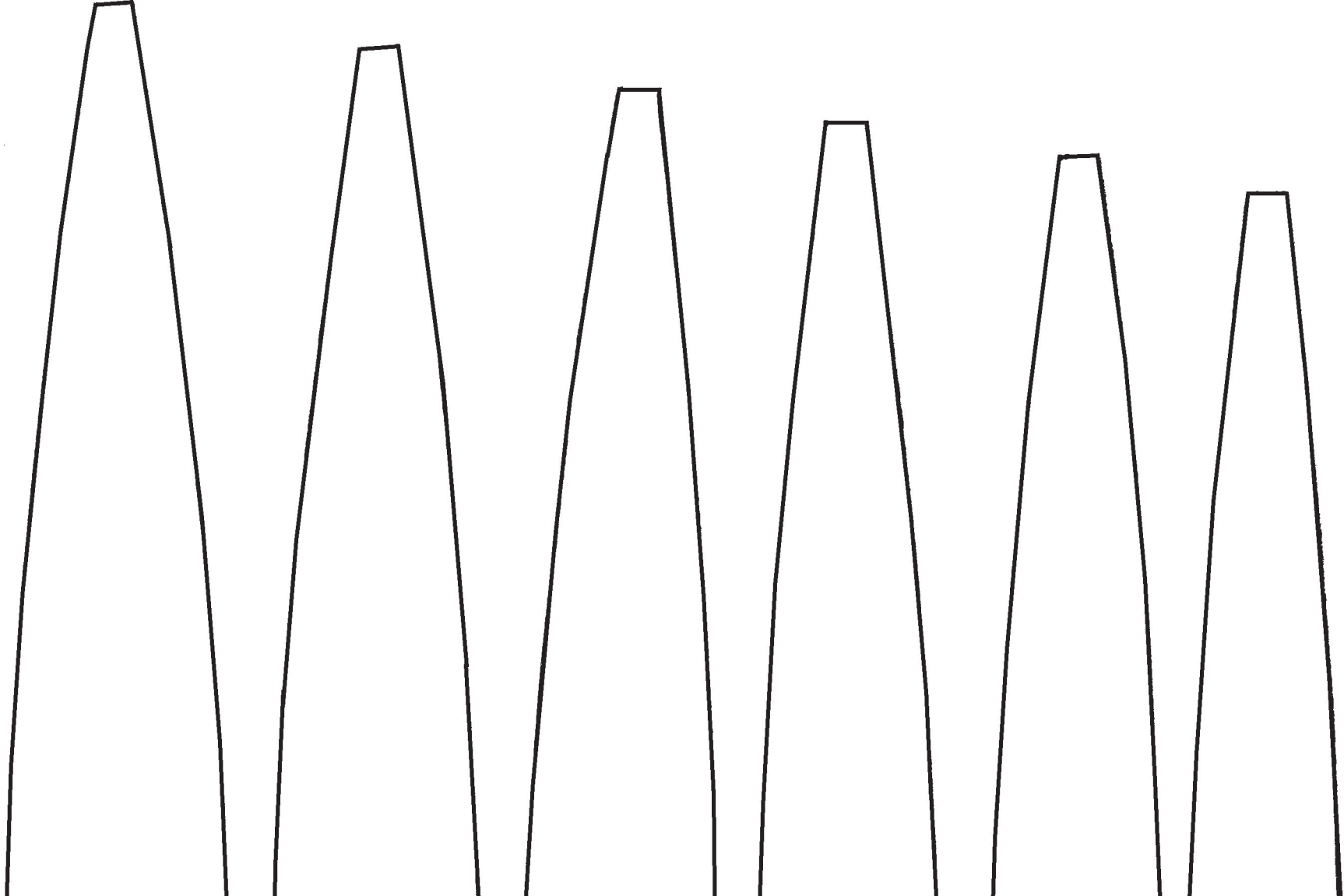

e-Dirty Birdy Twin
redesigned
by
Dan Grotzinger, January 2017

Copyright 2019
AMA
and
ModelAviation
Copying for resale of this drawing without
the written approval or consent of AMA
is expressly prohibited.

FU
Mod

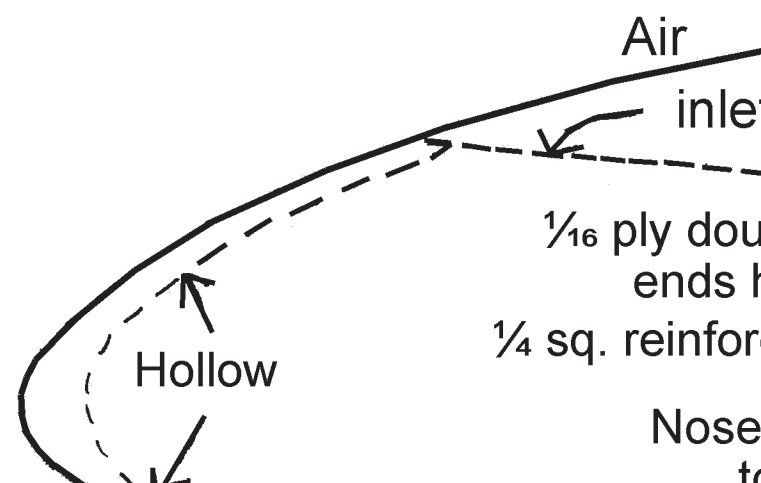

usage modification

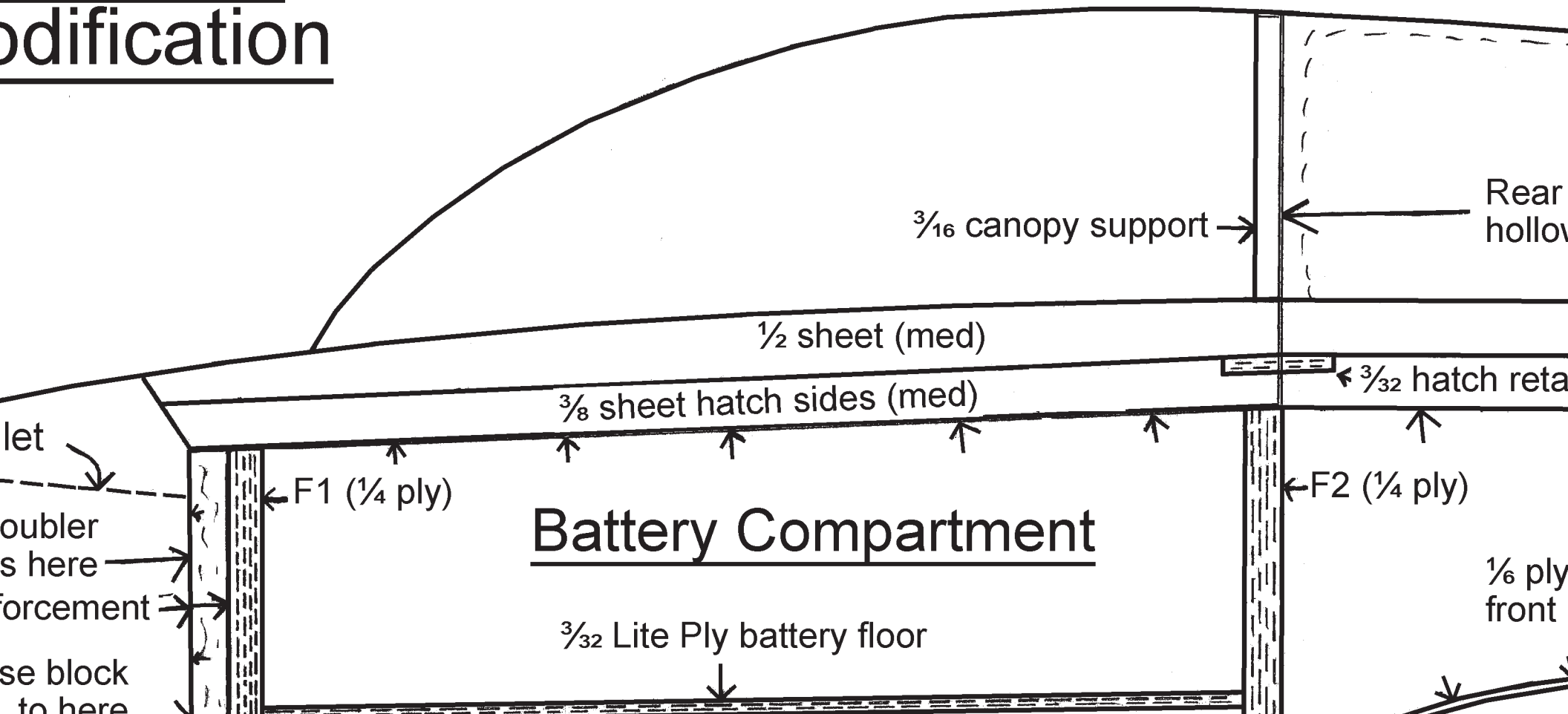

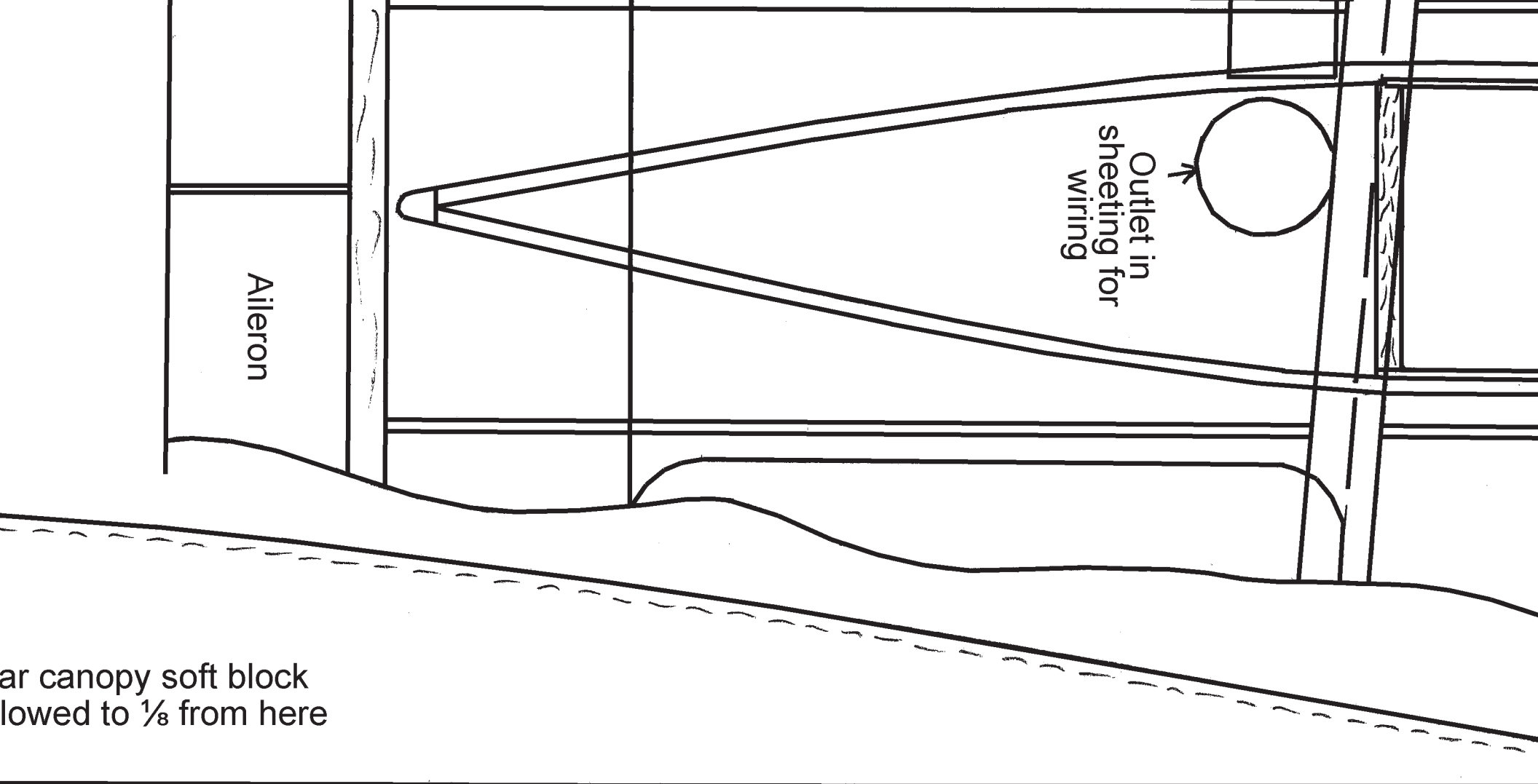

near canopy soft block
 lowered to 1/8 from here

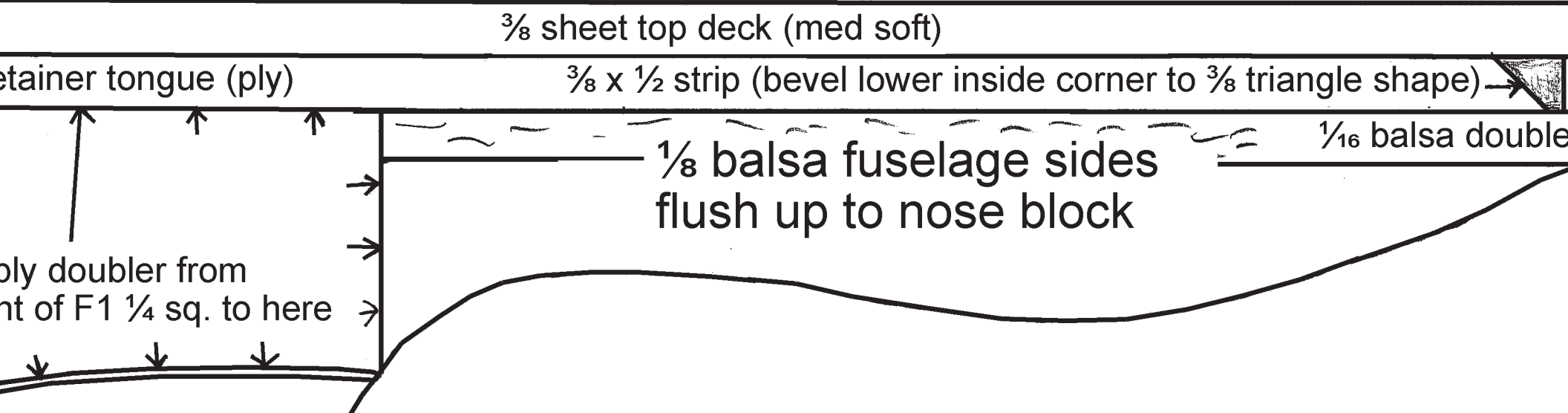

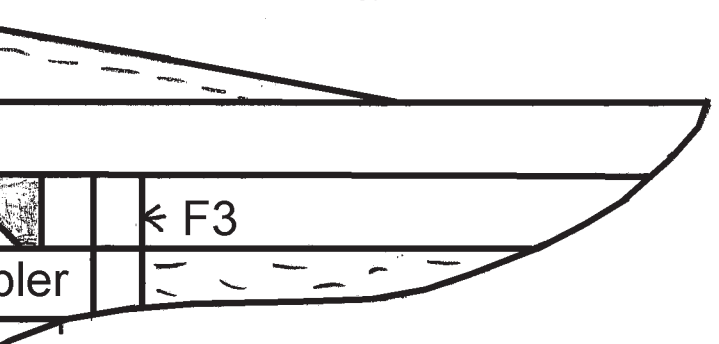
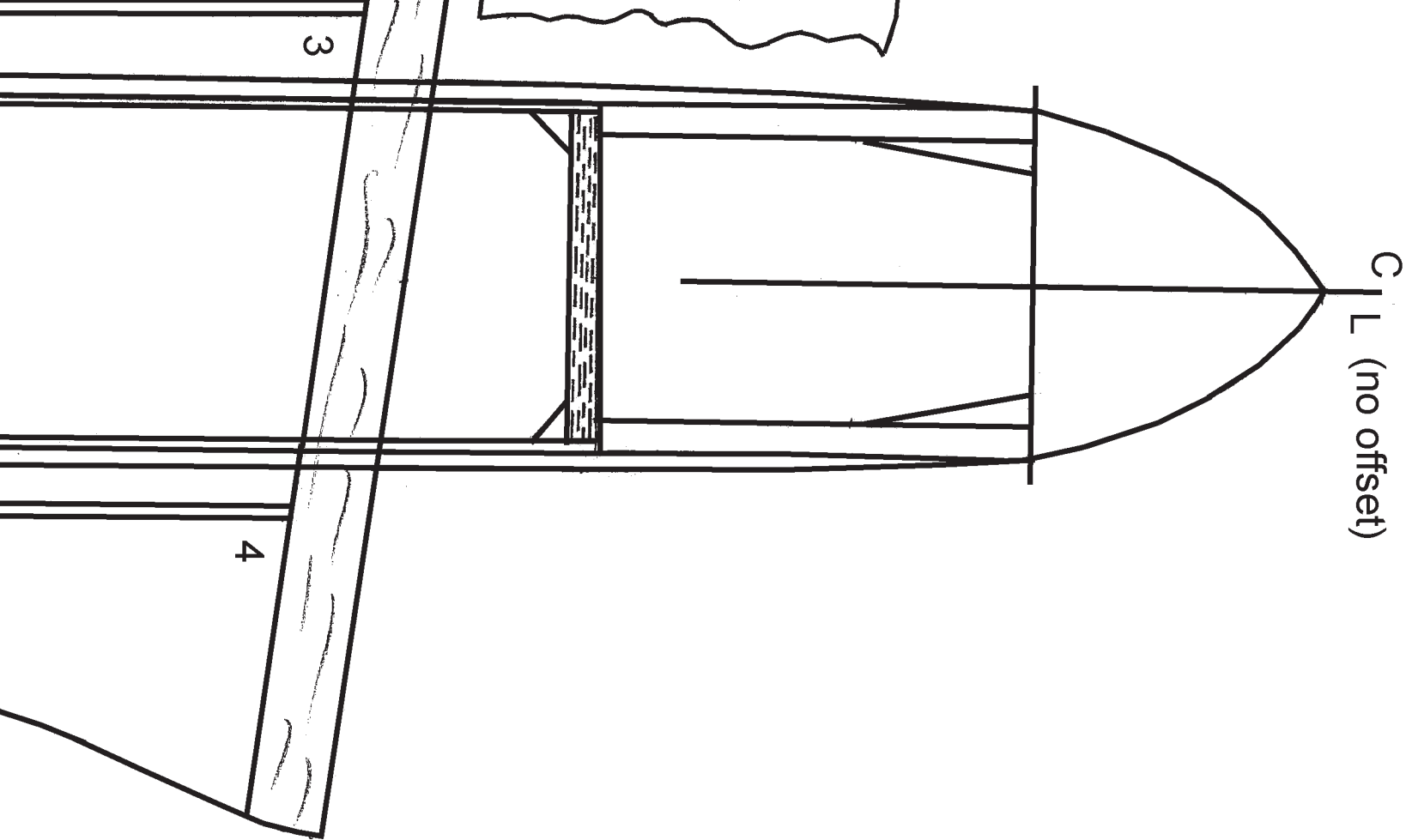

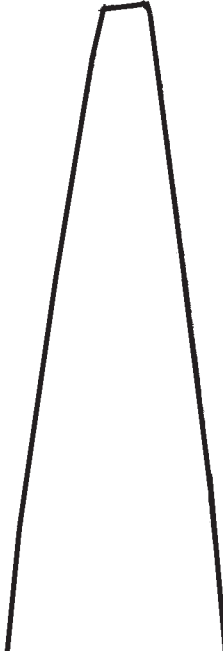
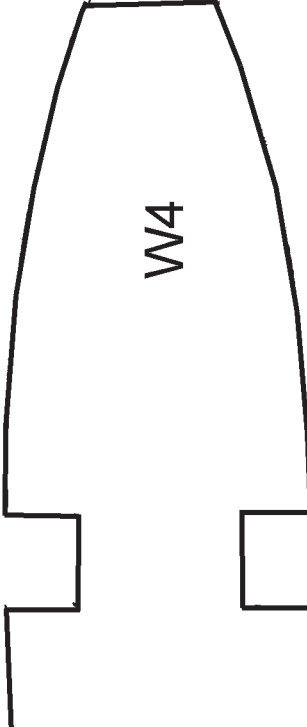
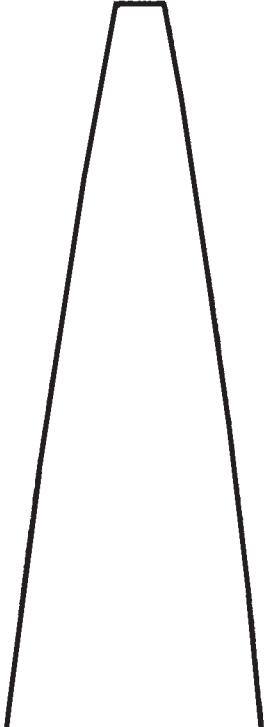
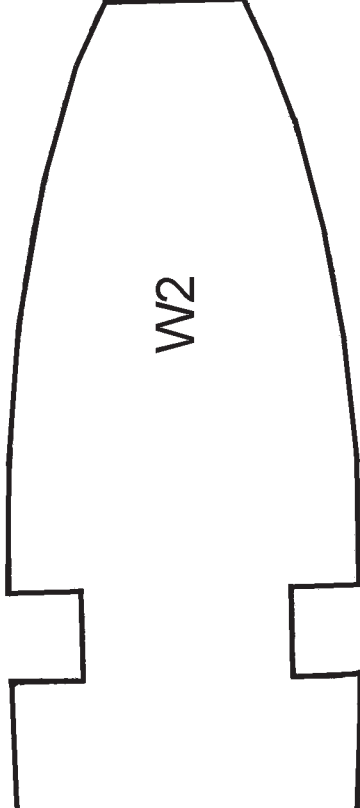
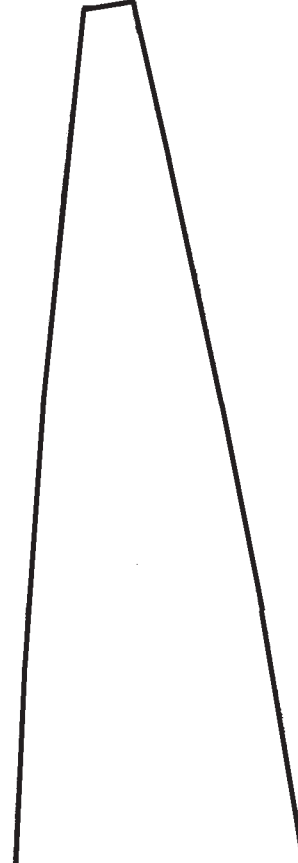
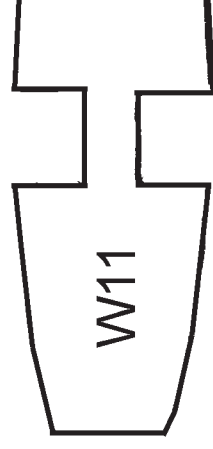
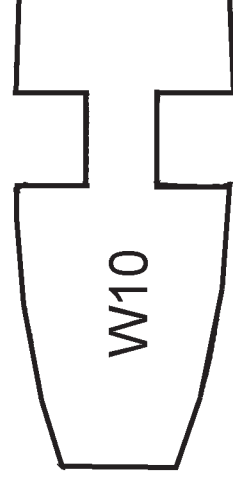
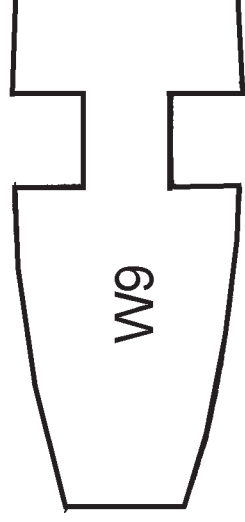
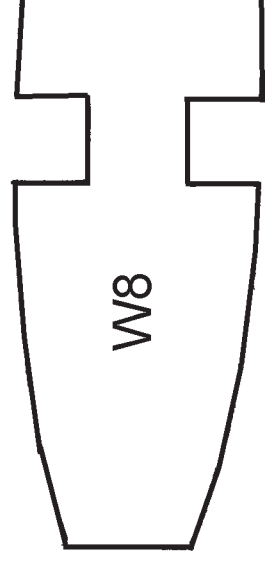
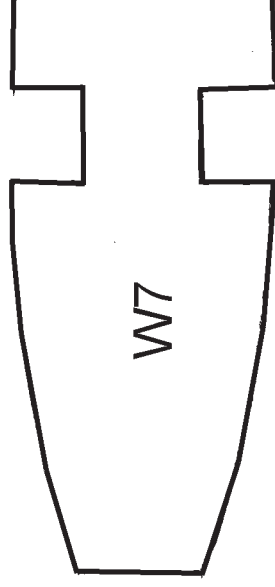
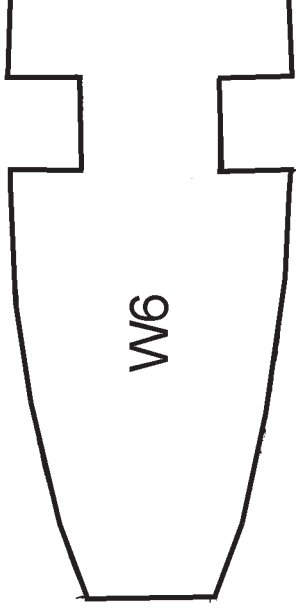

ce square



Sheet 3 of 3
e-Diary Birdy Twin
Designed
By
Dan Gotsinger January 2017

Copyright © 2017 by e-Designation
All rights reserved. No part of this publication
may be reproduced, stored in a retrieval system,
or transmitted in any form or by any means
electronic, mechanical, photocopying, recording,
or by any information storage and retrieval
system, without the written permission of
e-Designation.



Need
to
(lami
blocks w
on ce

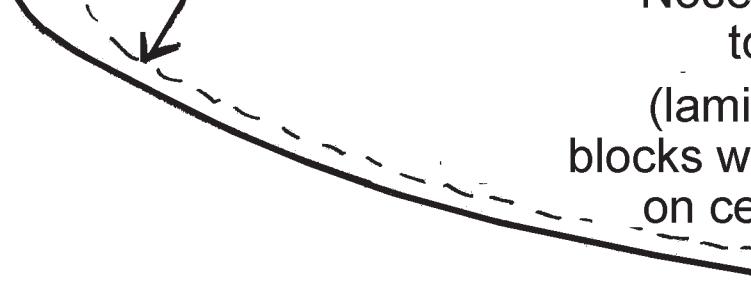

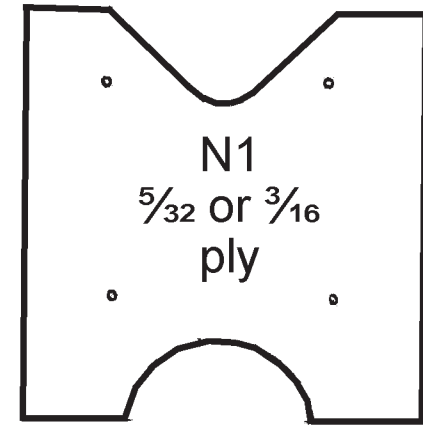
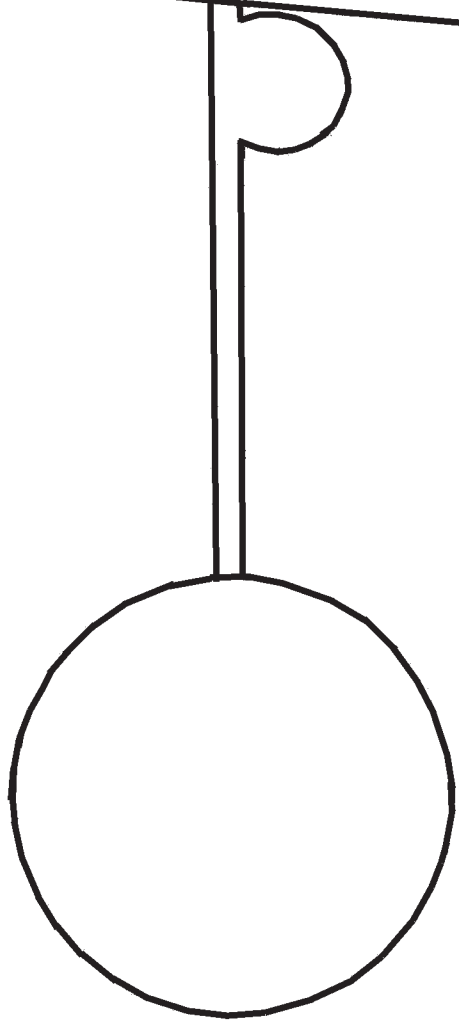
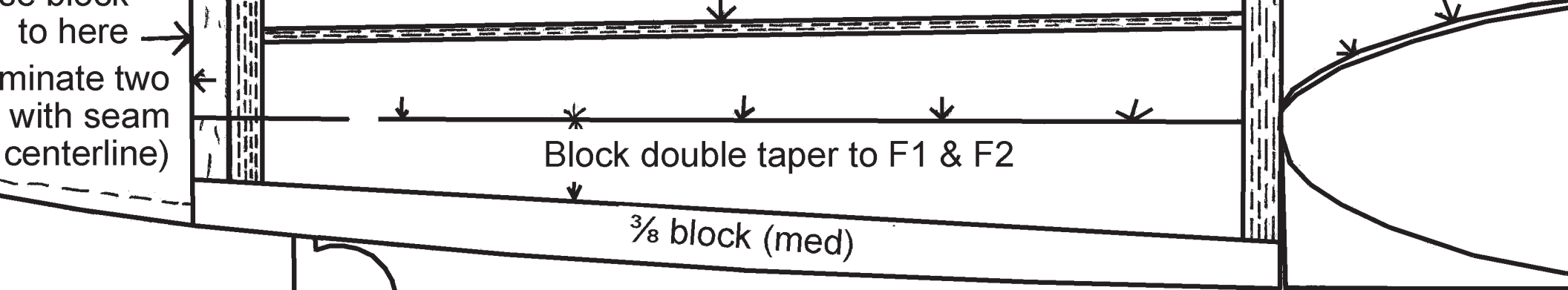

Nacelle (

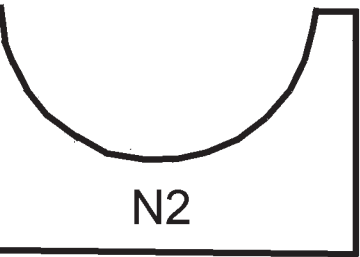
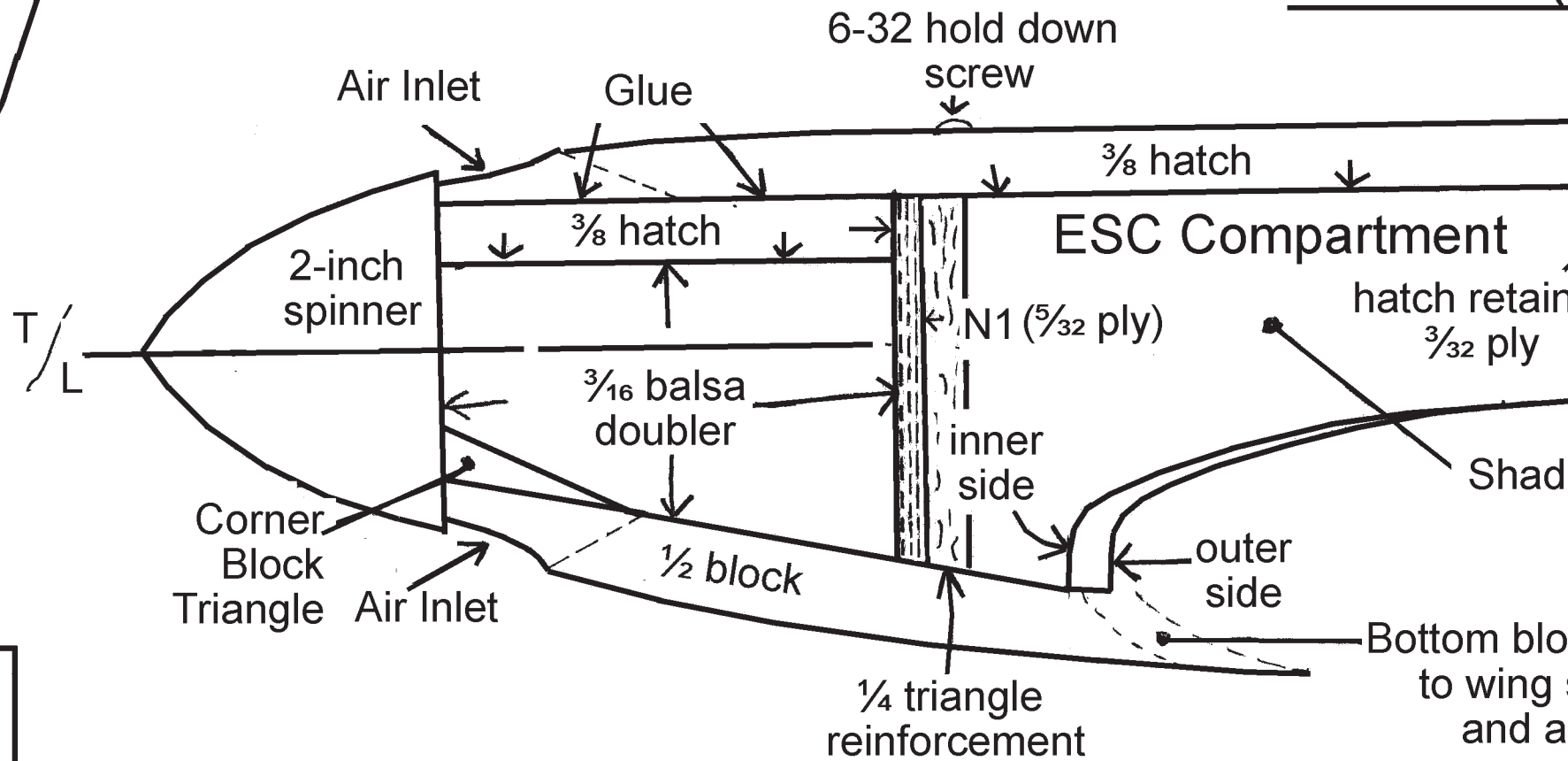

1 inch reference square



Copyright 2019  **AMA** and **ModelAviation**
ACADEMY OF MODEL AERONAUTICS
Bringing Modelers Together

Copying for resale of this drawing without the written approval or consent of AMA is expressly prohibited.

(make right & left)

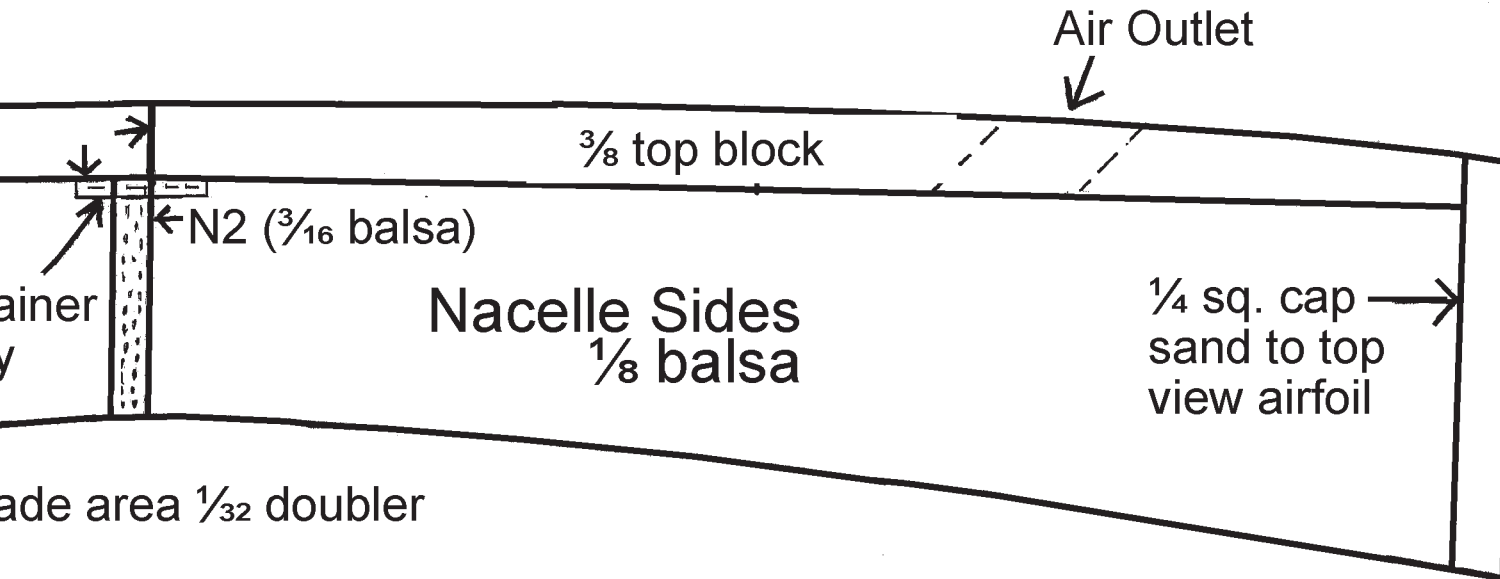

ade area 1/32 doubler

block tapers
g sweep
l airfoil

Sheet 1 of 3 Plan No. 1112

ntion
thout
AMA

e-Dirty Birdy Twin
redesigned
by
Dan Grotzinger, January 2017

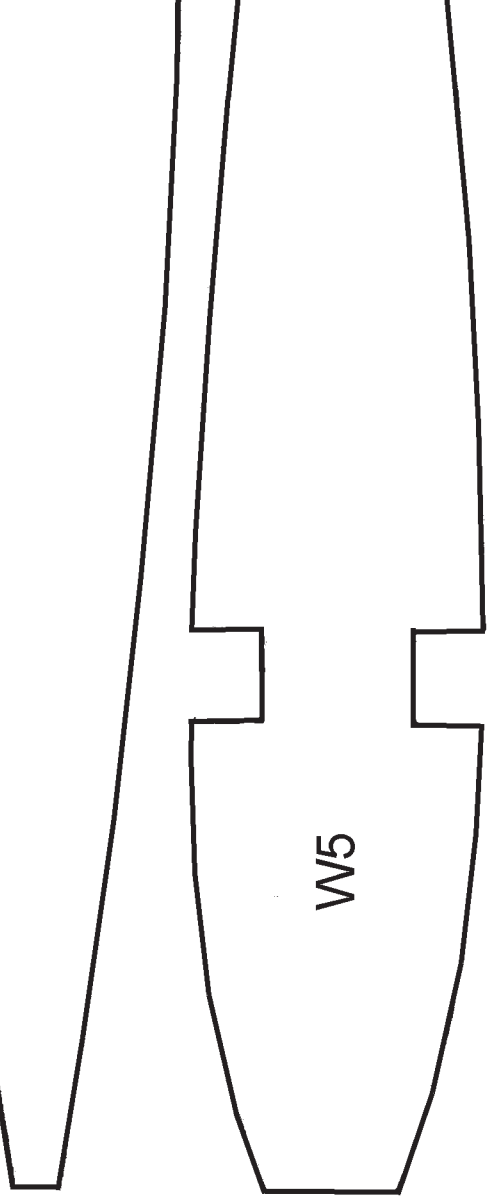
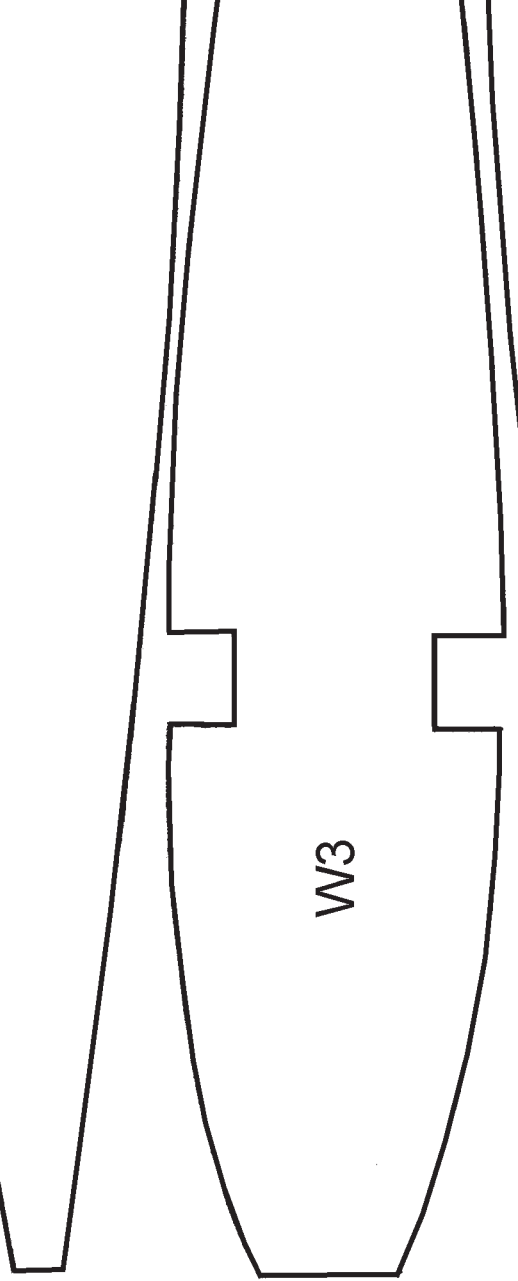
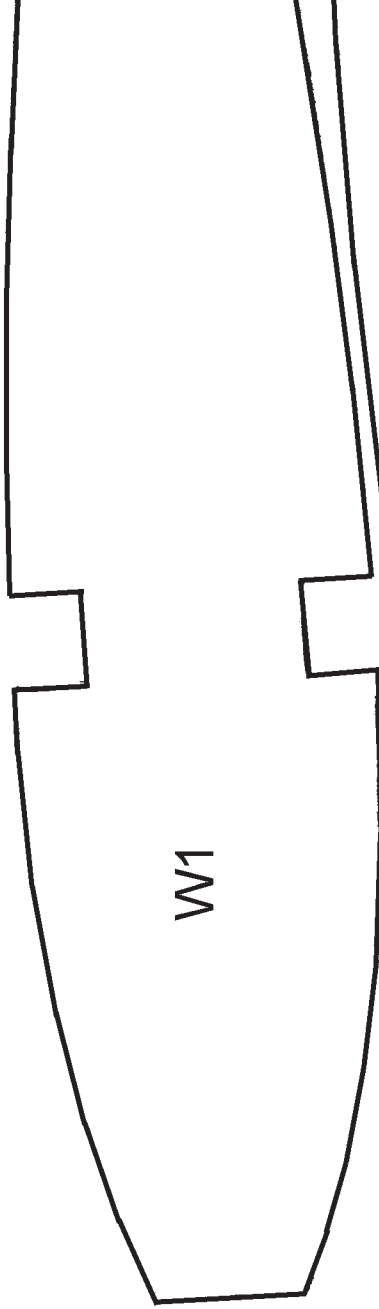

1 inch reference s



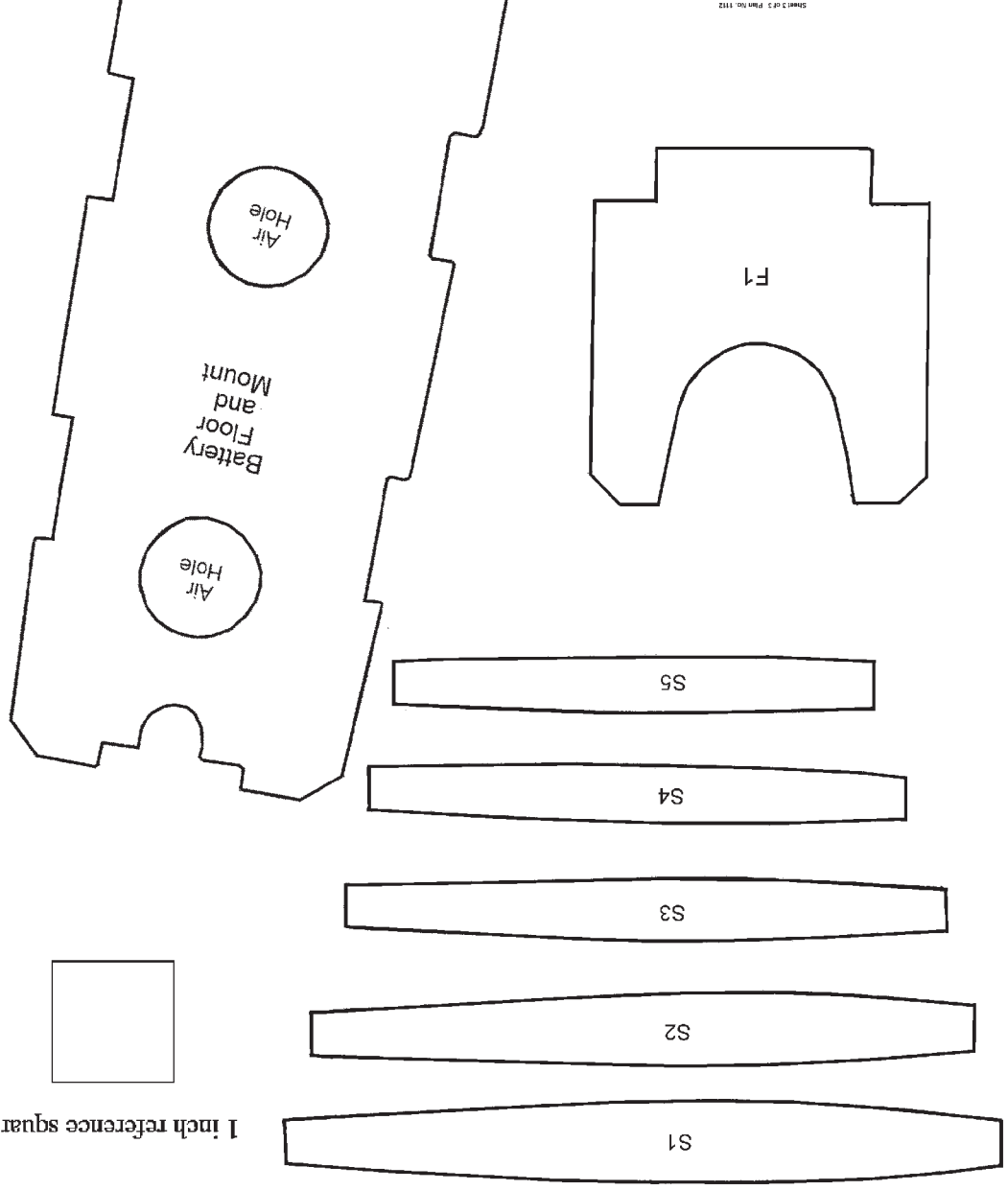

Battery Floor and Mount

Air Hole

Air Hole

F1

S5

S4

S3

S2

S1

1 inch reference square