

6 AND 1/16" SPAN BETWEEN CENTER
POD AND BOOM- FRONT AND REAR

GE

INSIDE

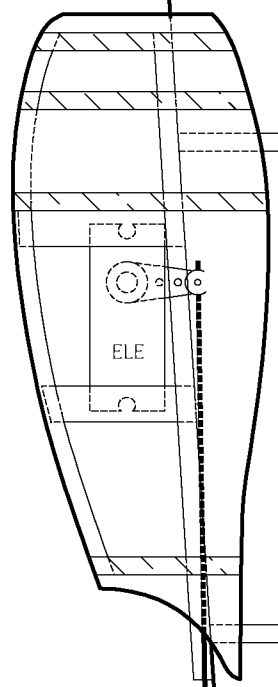

AND TAPE TO SHEET 4

BOOM/MOTOR ALIGNMENT TOOL- SEE TEMPLATE SHEET 3
BOOMS ARE GLUED TO HORIZONTAL AND WING BEFORE
THE CENTER POD- TOOL USED OVER MOTOR SHAFT

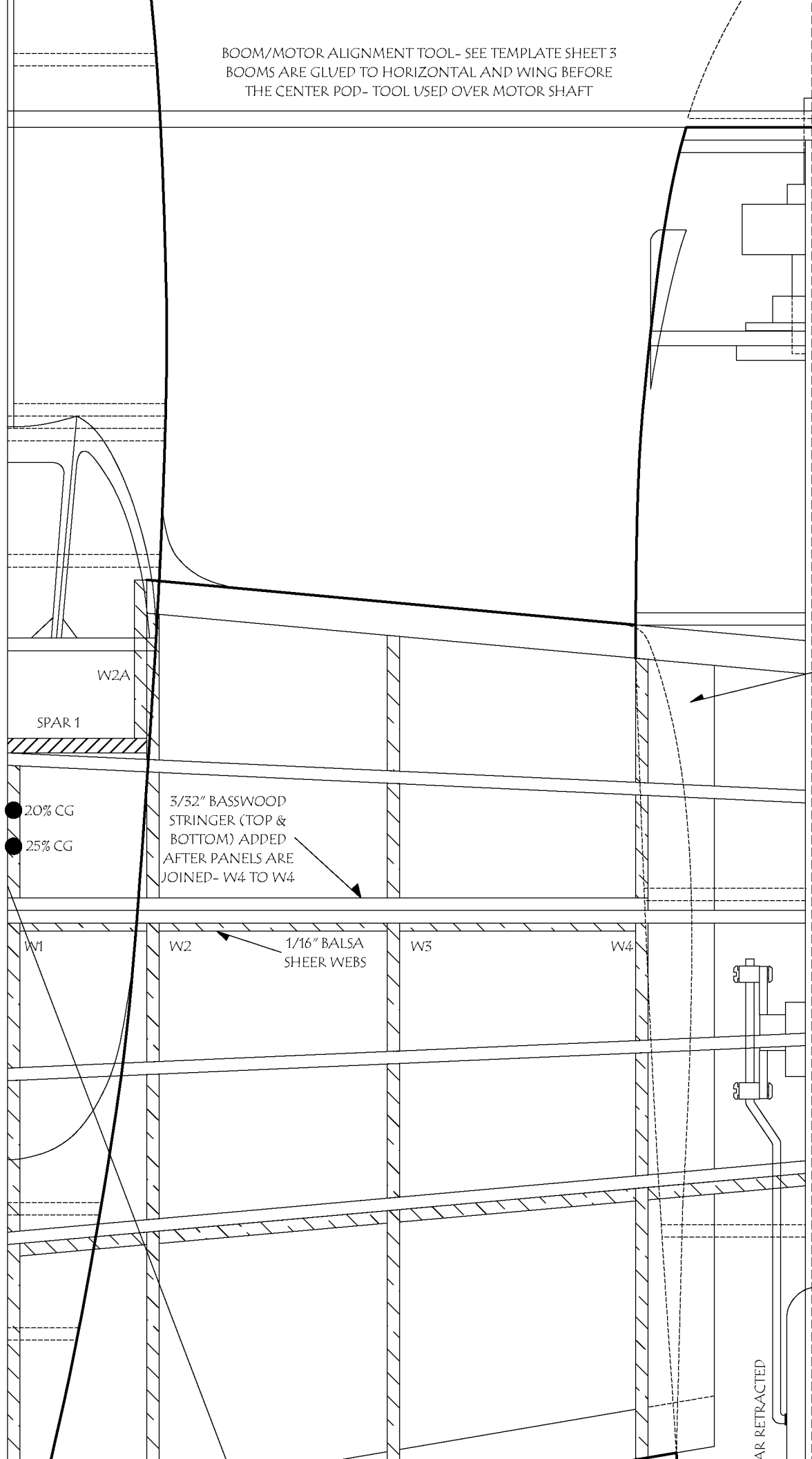

TRIM ALONG THIS LINE

AR RETRACTED

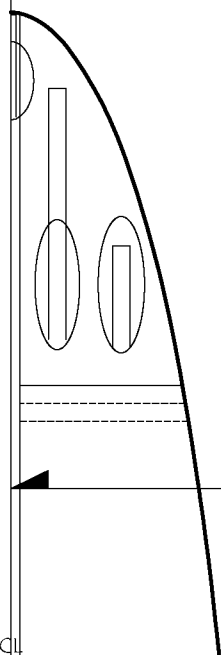

6 AND 1/16" SPAN BETWEEN CENTER
POD AND BOOM- FRONT AND REAR

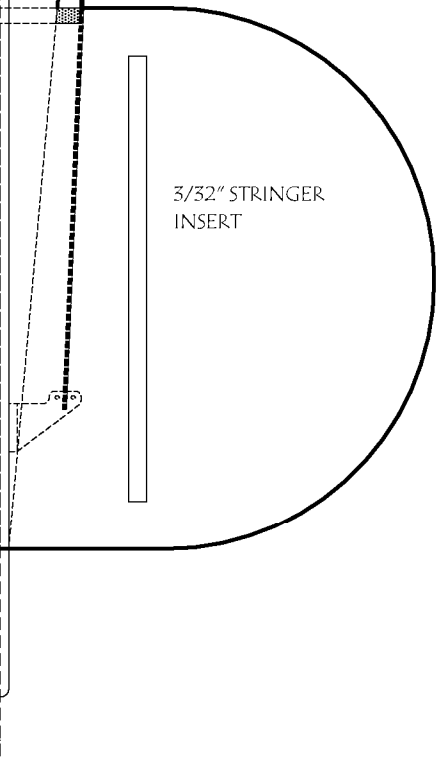

FOR CONSTRUCTION DE
BUILD AND COVERING I



TRIM TRAILING EDGE
WHEN BOOM IS ATTACHED

OUTSIDE

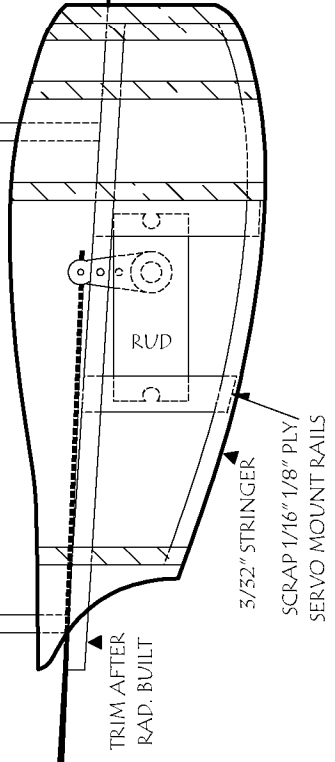

RIGHT OUTER RADIATOR



RADIATOR CENTER STRINGER TEMPLATE

RIGHT BOOM ELEVATOR AND RUDDER SERVOS MOUNTED
UP-SIDE DOWN AND WITH SPLINE TOWARDS THE FRONT

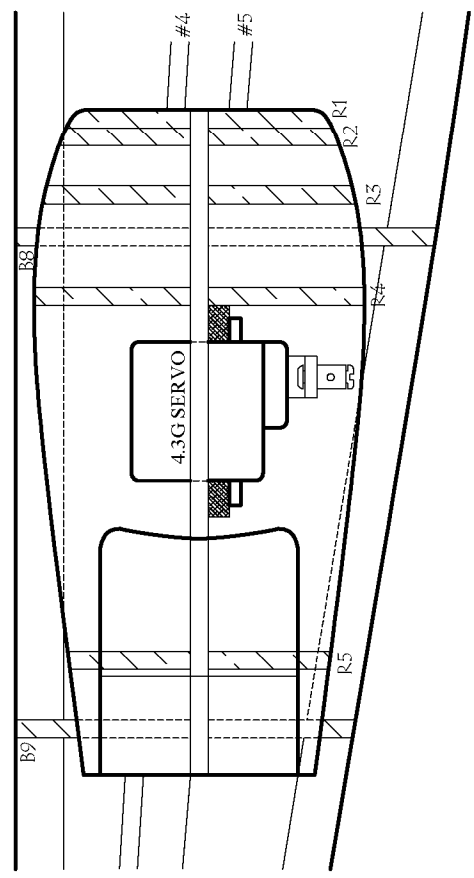

RADIATOR COVER TEMPLATES

RADIATOR COVER TEN

PLUG

RIGHT BOOM

PLUG-IN GEAR DETAIL
LOOKING FORWARD

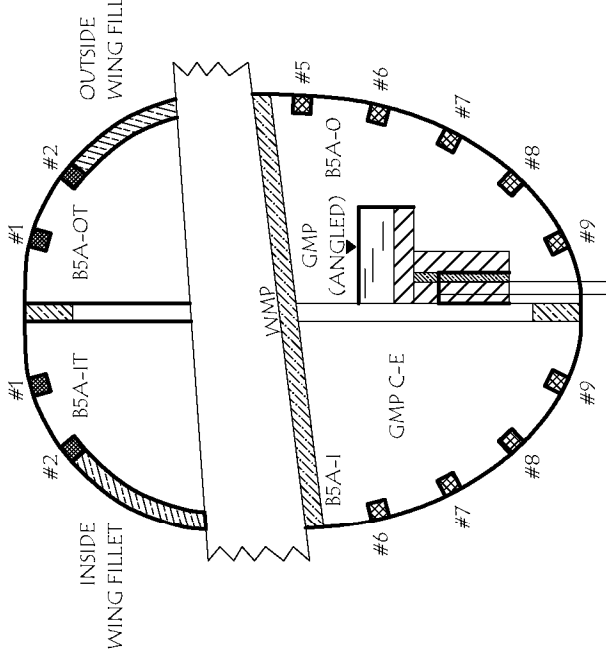

STRUT FROM 1/16" PIANO WIRE
STRUT IS JB WELD TO ROUND
TUBE AND INNER

1/16" Balsa SHEETING TOP AND
BOTTOM BETWEEN STRINGERS

LEADING EDGE FROM 1/4" Balsa- SEE TEMPLATE

RI

STRINGERS- 3/32" SC
MED-HARD Balsa
#1

20% CG ●

25% CG ● SCRAP 3/32"
SERVO PLATE

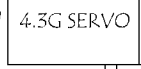

4.3G SERVO

W5

W6

W7

W8

#2

#5

#4

ALE

TE3

SCRAP

PIN HERE WH
IN WA

TRAILING EDGE FROM 3/32" x 3/8" CUT TO LENGTH SEE
THE DASHED LINES NEAR THE TIP TO HELP WITH SHAPING

9G SERVO

PLUG-IN GEAR DETAIL

PLASTIC CLIP- MADE FROM SODA BOTTLE

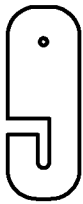

2 NEEDED

OUTER SQUARE TUBE
5/32" O.D., 1/8" I.D.

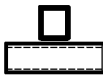

INNER SQUARE TUBE
1/8" O.D., 3/32" I.D.

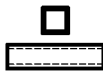

INNER ROUND TUBE
5/32" O.D., 1/16" I.D.

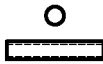

TUBING- BRASS OR ALUM.

PLUG-IN GEAR DETAIL
RIGHT BOOM LOOKING
TOWARDS THE WING TIP

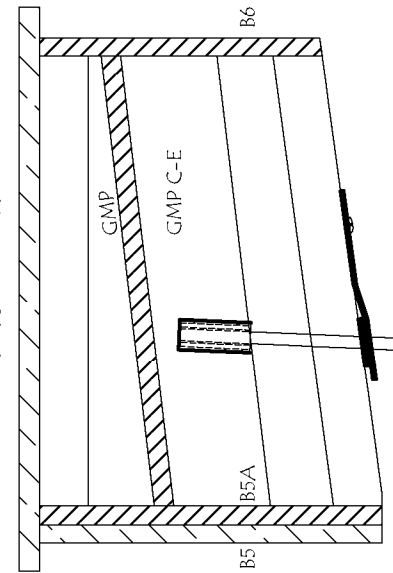

SEE "PLUG-IN NOSE GEAR PLAN"
FOR TUBING SIZES AND DETAILS

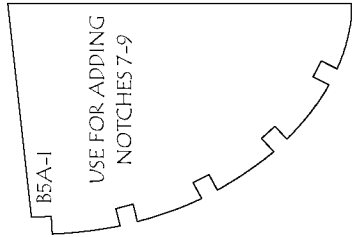

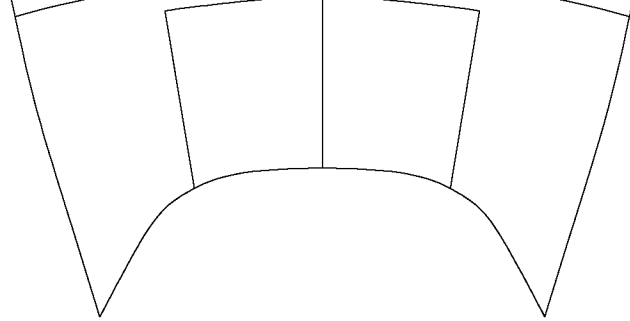

Copyright 2023  and **ModelAviation**

Copying for resale of this drawing without the written approval or consent of AMA is expressly prohibited.

CONTROL THROWS:
AILERONS +/- 3/8" - 1/2"
ELEVATOR +/- 1/2"
RUDDER +/- 1/2"

DETAILS SEE "P-38 INSTRUCTIONS"

POWER: TWO (2) 24g 1700 KV BL MOTORS
TWO (2) 12-15 AMP ESCS
2S 900-1100 MAH LIPO
TWO (2) 8" x 4.5" 3-BLADE PROPELLER

P-38 F LIGHTNING

DESIGNED BY DEREK MICKO-
40" WINGSPAN

10-12 OUNCES

CHANNELS: 5

MOTOR: 18-24 GRAM x2

ALL RIGHTS RESERVED

Plans No. 1138



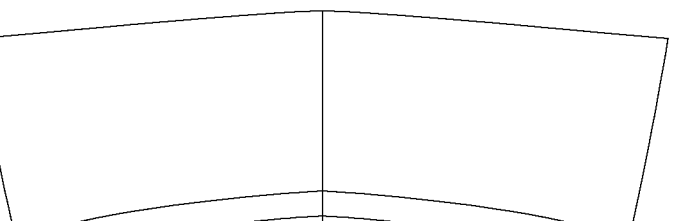
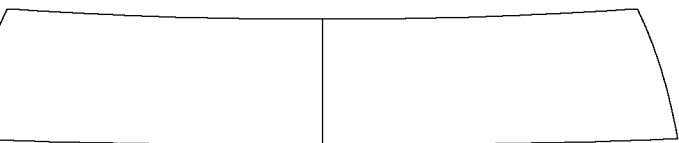
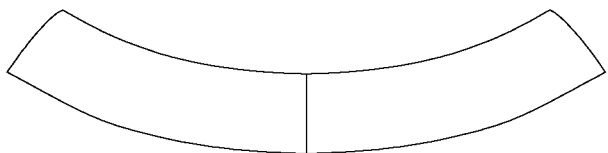
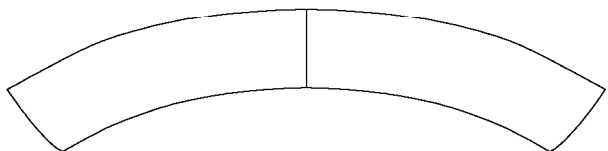
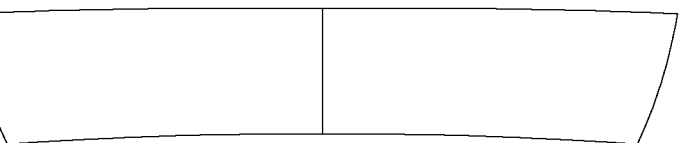
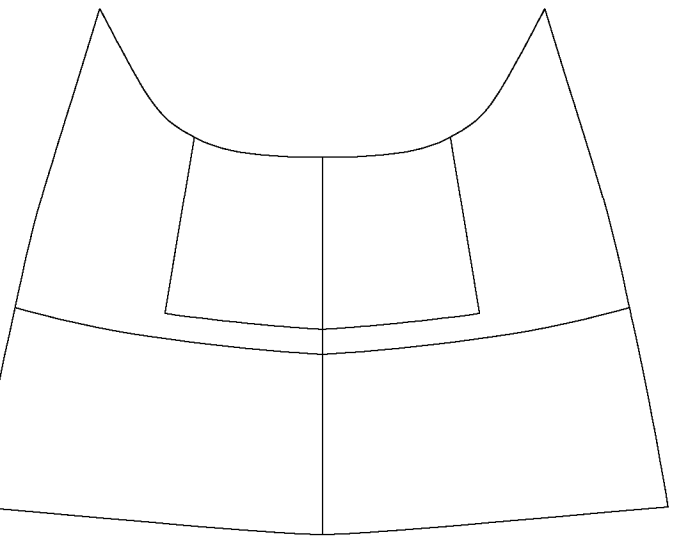

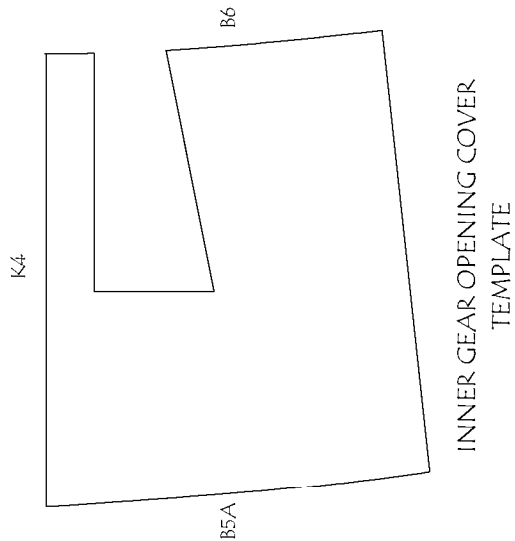
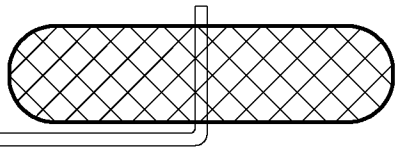

INNER GEAR OPENING COVER
TEMPLATE

RIGHT WING PANEL

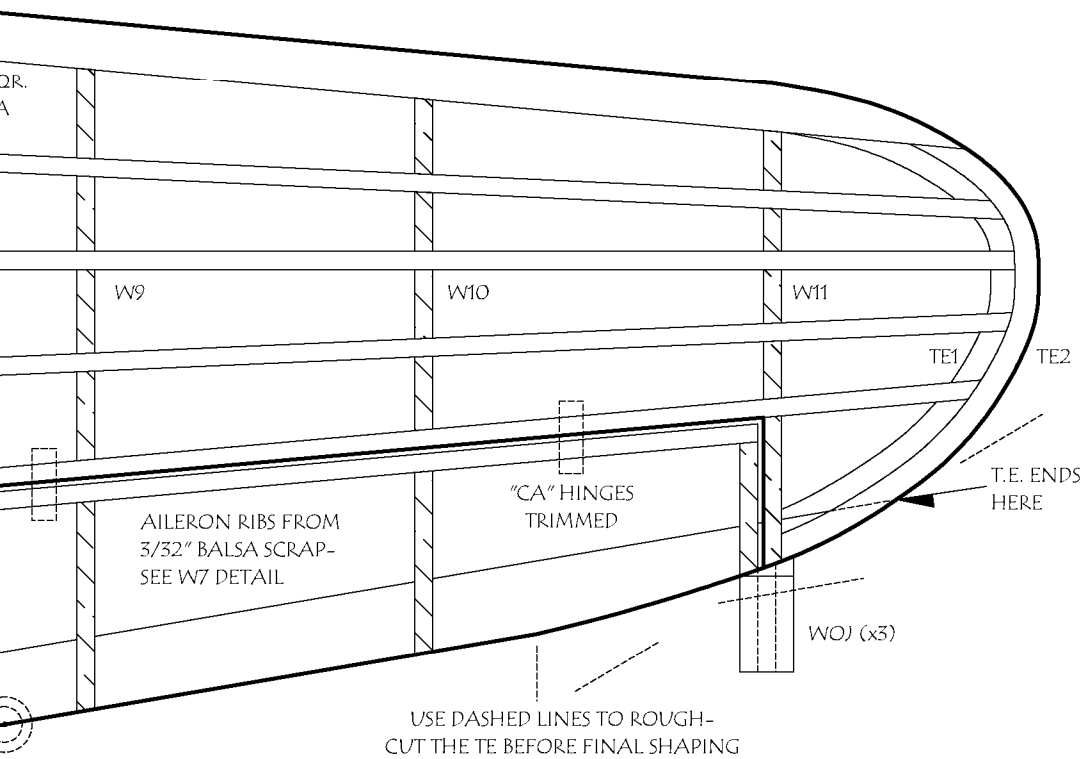

WHEN BUILDING
SHOUT

